



# ACPE 2024

ISPEs 16th Asian Conference on  
Pharmacoepidemiology

12-14 October 2024 • Tokyo

第16回 国際薬剤疫学会アジア会議

第29回 日本薬剤疫学会学術総会



Program Book

 ispe International Society  
for Pharmacoepidemiology



一般社団法人

日本薬剤疫学会

Japanese Society for Pharmacoepidemiology

特別協力：公益財団法人東京観光財団

## Welcome from ACPE2024 Local Host Committee Chair

Dear Colleagues,

I am writing on behalf of the host committee to extend a heartfelt invitation to you to attend the 16th Asian Conference on Pharmacoepidemiology (ACPE), scheduled to take place from October 12th to 14th, 2024, in Tokyo, Japan.

This conference is designed to enrich scientific dialogues and includes a variety of educational programs, opportunities for oral and poster presentations, and symposiums. These elements are integral in advancing health through the field of pharmacoepidemiology. We are eagerly anticipating your presence in Tokyo and look forward to the valuable contributions you will bring to our discussions.

Sincerely,

**Prof Nobuhiro Ooba**

ACPE Chair

Nihon University, School of Pharmacy, Chiba, Japan



## Welcome from ACPE2024 Program Committee Chair

Dear Colleagues,

Welcome to the 16th Asian Conference on Pharmacoepidemiology here in Tokyo! This conference presents a unique opportunity to explore new methodologies and approaches in pharmacoepidemiology, with a focus on the diverse healthcare landscapes and research across Asia. We will also be examining key topics such as the use of real-world evidence in regulatory decision-making, the role of AI and machine learning in the field, COVID-19 and other infectious diseases, and the safety of medications across various medical fields. I am confident that these sessions will provide valuable insights and foster collaboration both within our region and beyond, reflecting the significant advancements in pharmacoepidemiology studies in Asia over recent years.

I would like to sincerely thank our speakers, presenters, committee members, the ISPE and the JSPE, and everyone involved in the submissions and reviews of the program. Your contributions have made this conference possible and underscore the growing strength of pharmacoepidemiology in Asia. Thank you for being a part of ACPE 2024, and I look forward to our time together.

Sincerely,

**Hiraku Kumamaru, MD**

ACPE Program Committee Chair

Associate Professor, Healthcare Quality Assessment  
University of Tokyo



## Welcome from ACPE International Steering Committee (ISC) Chair

As Chair of the ACPE ISC at the International Society of Pharmacoepidemiology (ISPE), I am delighted to welcome you to ACPE 2024 in Tokyo, Japan. This year's conference marks a historic milestone for ACPE, with the largest number of abstracts ever submitted in our 16 conferences hosted across the Asia Pacific. ACPE was founded over 20 years ago by pioneering pharmacoepidemiologists in the Asia Pacific who recognized the need and potential for growth in this field in our region.

Over the past 15 conferences, we have witnessed significant advancements in pharmacoepidemiology, including the development of data resources and infrastructure, the rise of a new generation of pharmacoepidemiologists, impactful evidence informing medical and pharmacy practices and policies, and strong collaborations among academia, industry, and governments across the Asia Pacific.

We look forward to continuing this momentum together in Tokyo.

Sincerely,

**Soko Setoguchi, MD, DrPH, FISPE**

ACPE ISC Chair  
Professor of Medicine and Epidemiology  
Rutgers University



## Welcome to ACPE 2024 from the ISPE Immediate Past President

On behalf of the International Society of Pharmacoepidemiology (ISPE), I warmly welcome you to the Asian Conference in Pharmacoepidemiology in Tokyo, hosted in collaboration with the Japanese Society of Pharmacoepidemiology.

This meeting promises insightful discussions, collaborative opportunities, and innovative insights into pharmacoepidemiology against Tokyo's vibrant backdrop. Our shared commitment underscores the importance of international collaboration in addressing health challenges.

Join us for dynamic exchanges, keynote presentations, workshops, and networking sessions that contribute to advancing our field. Beyond the scientific program, explore Tokyo's cultural heritage and hospitality.

Welcome to Tokyo and to the Asian Conference in Pharmacoepidemiology!

With kindest regards,

**Lisa G. Pont, FISPE**

Associate Professor & Team Lead Medicines Use  
Research in Aged Care (MURAC)  
University of Technology Sydney



# Venue

**Hongo Campus – The University of Tokyo**  
7-3-1 Hongo Bunkyo-ku, Tokyo



## ■ From airports

### **From Haneda Airport**

Haneda Airport Terminal 3 (Keikyu Airport Line) – Keikyu Kamata (Keikyu Main Line) – Shinagawa (JR Keihin Tohoku Line) – Tokyo (Tokyo Metro Marunouchi Line) – Hongo Sanchome

### **From Narita Airport**

Keisei Narita (Keisei Main Line) – Aoto (Keisei Oshiage Line) – Oshiage (Toei Asakusa Line) – Kuramae (Toei Oedo Line) – Hongo Sanchome

## ■ From the nearest stations

Hongo Sanchome (Tokyo Metro Marunouchi Line) 8-minute walk

Hongo Sanchome (Toei Oedo Line) 6-minute walk

Yushima Station or Nezu Station (Chiyoda Subway Line) 8-minute walk

Todaimae Station (Namboku Subway Line) 1-minute walk

Kasuga Station (Mita Subway Line) 10-minute walk

# Venue Information



Building Name	Yasuda Auditorium	Sanjo Conference Hall	Faculty of Engineering Bldg. 2	Ito International Research Centre	Faculty of Medicine Bldg. 1	Takeda Bldg.
Code	<b>Venue Y</b>	<b>Venue S</b>	<b>Venue E2</b>	<b>Venue Ito</b>	<b>Venue M1</b>	<b>Venue T</b>
Registration	Oct.12-14			Oct.13-14 (+evening of 12)		Oct.12 only
Education	Track D	Track A Track C				Track B
Oral	Room 1	Room 2		Room 3	Room 4 Room 5	
Poster			Poster 1	Poster 2  Poster Spotlight 1/2		
Social Programs, Exhibition Desks, etc.	ISPE/JSPE Desk TCVB Desk(Tour) Coffee Break	Coffee Break		Welcome Reception (Oct. 12) Exhibition Coffee Break Pray Room		

# Guide to the Attendees

## IMPORTANT!

**IN Room 1 (Venue Y) and Room 3 (Venue S), Eating and drinking are prohibited.**

**(You are allowed to bring your drink inside if it has a lid.)**

**Eating and Drinking are allowed at the designated area in the building.**

## Registration

Please show us your QR code at the registration desk, either from your device or print out. After scanning your QR code, your name card will be printed out.

You can find the QR code through the registration site. After login, click “16th ACPE and 29th JSPE LHC” (\*For scholarship recipients and Educational Speakers, please also click “16th ACPE and 29th JSPE LHC”) In the upper right-hand corner of the site, you will find an orange button titled “QR Code for Check-In.” After clicking the orange button, click the “Download PDF” button. You can either display the PDF from your device or print it out and bring it to the registration desk.

## NOTE 1

All buildings on the Hongo campus will be unlocked at 8:00 AM. This is a rule of the University of Tokyo. This means that conference staff will enter the building at 8:00 AM. As soon as the staff is prepared, we will start the registration desks. Thank you for your cooperation in advance.

Bldg.	Saturday 12 Oct.	Sunday 13 Oct.	Monday 14 Oct.
Yasuda Auditorium	08:05 – 19:30	08:05 – 18:15	08:05 – 16:00
Ito International Research Center	19:00 – 20:45	08:05 – 17:30	08:05 – 16:00
Takeda Building	08:05 – 17:00	—	—

## NOTE 2

### Registration for the Educational Session on Saturday.

- Educational Session Track B will be held in the Takeda Building. Those joining Track B, please approach the Takeda Building directly.
- Tracks A & C will be held in the Sanjo Conference Hall building (Venue S), and there is **NO** registration desk in that building. Those attending Tracks A & C, please go to Yasuda Auditorium (Venue Y) to receive your name cards and tickets before proceeding to Venue S.
- Track D will be held in Yasuda Auditorium, so those who attend Track D, get Name card and tickets at Venue Y and attend the track at the same building.

## Participation Certificate

The certificate will be available for download from the registration system at the end of October. Once it is ready, we will contact all participants.

## Lunch

Lunch for participants will be served on Sunday, Oct. 13, and Monday, Oct. 14. Please pick up a lunch ticket at the registration desk each day. Lunch will be served in different buildings and in different styles:

Note: No lunch will be provided on Saturday, Oct. 12.

Location	Style	Note
Central Dining Hall (below Yasuda Auditorium) & Second Dining Hall	Cafeteria with various menus available.	Vegetarian and Halal menus available.
Ito International Research Centre	Lunch boxes to be eaten in Room 3.	Limited number of vegetarian boxed lunches available.

## Wi-Fi

There are three Wi-Fi services available for external visitors. Each service is available to a different scope of users, and some may require pre-registration. Please refer to the following QR code for details:



In Venue S (Sanjo Conference Hall) and Venue ITO (Ito International Research Centre), there are building-specific Wi-Fi services available with IDs and passwords. Information for using Wi-Fi will be displayed at the venues.

## Refreshment

Some refreshments will be available at the following locations:  
Service hours are indicated on the schedule.

- Venue Y: Lobby on the 2nd floor (Please note you must not bring any drinks or food into the room.)
- Venue S: Lobby on the 2nd floor (Please note you must not bring any drinks or food into the room.)
- Venue ITO: Lobby on the B2F
- Venue T (Only Saturday, Oct. 12): Lobby on the 5th floor.

## Refreshments - Tea Ceremony

Experience the tradition of Japanese tea at our tea ceremony hosted by Nihon University's Tea Ceremony Club. Join us on the 2nd floor of Yasuda Auditorium (Venue Y) on Sunday, October 13th (11:00 AM - 3:00 PM) for a unique cultural performance and complimentary cup of tea.

## Free sightseeing tour and information desk

Tokyo Convention & Visitors Bureau is offering complimentary programs specially tailored to provide overseas registered participants with various experiences of Tokyo and its vicinity, from nature and culture to other attractions.

Please sign up for the tours at the **TOKYO CITY INFORMATION DESK** located near the registration area at Yasuda Auditorium (Venue Y). The tour registration will begin at the same time as the conference registration, and the registration for the tour on the 14th will also open on October 12. If capacity is reached, a waiting list will be available.

Please check out the website for tour details and noticed that the tour courses are subject to change.

Tour Name	Date	Time	Capacity
T-A Meiji Shrine & "SHIBUYA SKY"	Oct. 12 (Sat)	AM 9:00-12:30	40
T-B Tokyo River Cruise & Hamarikyu Gardens	Oct. 12 (Sat)	AM 9:00-12:30	40
T-C Tokyo River Cruise & Hamarikyu Gardens	Oct. 12 (Sat)	PM 13:30-17:00	40
T-D Meiji Shrine & Harajuku Walking Tour	Oct. 12 (Sat)	PM 13:30-17:00	40
T-E Tokyo Tower (Main deck) & Odaiba Area	Oct. 14 (Mon)	PM 18:00-21:00	40
T-F Tokyo SKYTREE (Tembo Deck) & Tokyo Solamachi	Oct. 14 (Mon)	PM 18:00-21:00	40

\*Please check out the website for tour details and be aware that tour courses are subject to change.

## Social Programs

### Welcome Reception

- Date and Time: Saturday, Oct. 12, 19:30 – 21:00
- Venue: Venue ITO, B2F
- Style: Standing buffet with drinks and snacks
- Dress code: Casual

### Conference Dinner \*Ticket required

- Date and Time: Sunday, Oct. 13, 19:00 – 21:00
- Venue: Gakushi Kaikan (approx. 15 minutes from the University of Tokyo by taxi, around 1,500 JPY)
- Transportation: Please note that there will be NO transportation services to the dinner location, please kindly find below the suggest methods.

**Taxi:** The nearest taxi stand is in front of the University Hospital (see map).

**Subway:** Take the Toei Oedo Line from Hongo-sanchome Station and ride for 1 stop, getting off at Kasuga Station. Then, transfer to the Mita Line and ride for 2 stops, disembarking at Jimbocho Station and exiting through Exit A9.

**Bus:** Take bus東43 (East 43) at Todai-Akamon (directly outside the Ito International Research Center Gate on the same side of the street). Get off at Kanda-Nishikicho (approx. 20 minutes).

- Style: Buffet
- Dress code: Business Casual

### Emergency Contact: Police: 110 Fire / Ambulance: 119

JNTO operates a visitor hotline 24 hours a day, 365 days a year. Call for tourist information or assistance in the case of accidents and emergencies. From Japan 050-3816 2787 From Overseas +81-50 3816-2787



# Information for Presenters

## ■ Oral presentations

- Each oral presenter is allocated a total of 15 minutes.
- Oral presentations should be 8-10 minutes, with 5-7 minutes discussion (no longer than 15 minutes total).
- Chairpersons for each session will be instructed to strictly maintain these time limits to allow registrants to move between parallel sessions so they can hear discussion of particular papers in which they have interest. The moderators will stop your presentation at 12 min to reserve a minimum of 3 min question/discussion time.
- Presentations will be delivered from a PC.
- Presenters are not able to use their own laptop.
- Please upload your PowerPoint file to the Dropbox link in advance.
- There will be no central presentation data drop-off spot. If you do not upload the PowerPoint file in advance, please bring your file on a USB stick to your session room and provide it to the audio-visual technicians at least 2 hours prior to your session.

## PowerPoint slide formatting

- PowerPoint slides should be prepared in English.
- PowerPoint slide format should be 16:9.
- Each slide should contain no more than 4-5 bullet points, with each bullet limited to 6 to 8 words and font no smaller than 24 points
- Conflict of Interest Statement: You must disclose financial and other interests of each author/ presenter that may pose a conflict of interest or an appearance of a conflict of interest soon after the title slide.

## ■ Poster presentations

### Overview

Poster sessions are designed to give presenters an opportunity to discuss informally their research with colleagues interested in their research. The purpose of the posters is to visually stimulate interest in the research, to present sufficient information for viewers to understand the methods, results, and significance of the research, and to promote conversations and networking among conference participants.

- Total poster size must be 841 millimetres wide x 1189 millimetres high (A0 size). The poster must be printed in portrait format. Posters larger than this size cannot be accommodated. Posters must be prepared in English.
- Scientific content should prioritize clear communication of the intended message using straightforward, accessible language.
- Make font readable! Text and diagrams should be arranged appropriately so that the poster is legible from a distance.

- Conflict of Interest Statement: Potential conflicts must be listed on the poster as the first section after the title and in a type size consistent with the rest of the poster. This statement must list all funding sources for the current project, as well as other potentially conflicting relationships that existed at any time during the conduct of the study.
- Posters must be pinable, so please make sure you are using material that is light in weight. Pins will be provided on the day.
- Important: Posters printed on cloth / organic bases are encouraged.
- Numbering System: Each poster board will be numbered. Presenters should attach their posters to the board number corresponding to the number assigned to their poster on that day as listed in the Final Program.
- Posters will be on display on the day of your presentation and can be removed at the end of the afternoon break on that day. Please note that posters will be discarded at the end of each day if they have not been removed.

Date	Set up	Removal
For October 13 (Sun.)	8:00 – 10:00 am	4:45 – 6:00 pm
For October 14 (Mon.)	8:00 – 10:00 am	4:00 – 5:00 pm

# Important Notice

## Oct.12: New Time Schedule for Educational Session Track A & C

Please note that the start time has been changed from 8:30 to 9:10 and the time schedule has been adjusted as follows.

### Track A

- 09:10 - 09:40 Designing PE studies
- 09:40 - 11:10 Principles of PE
- 11:10 - 11:40 Coffee Break
- 11:40 - 13:10 Eval. of Clin. Outcome
- 13:10 - 14:10 Lunch on your own
- 14:10 - 15:40 Practical skills: protocol
- 15:40 - 16:10 Coffee Break
- 16:10 - 17:30 Practical skills: programming

### Track C

- 09:10 - 09:30 Designing Studies
- 09:30 - 11:00 Principles
- 11:00 - 11:15 Coffee Break
- 11:15 - 12:45 Principles
- 12:45 - 13:45 Lunch on your won
- 13:45 - 14:15 Structure of a study protocol
- 14:15 - 15:30 Protocol Writing
- 15:30 - 15:45 Coffee Break
- 15:45 - 16:45 Statistical Analytic Programming
- 16:45 - 17:45 Critical Appraisal of a study article

## Oct.14: Venue Change for Symposium 10

Please be aware that the venue change of Symposium 10: Medical Device Epidemiology in Asia.



**South Clinical Research Building (3F)**

**Symposium 10**

Tetsumon Clinical Lecture Hall

Oct.14 8:30-10:00

The main entrance is closed, so please enter the building from the Café entrance. Do not enter the Café, but follow the corridor to the right, and immediately turn left. After a short walk down the corridor, you will see an elevator on your left. Please go to the 3rd floor. The lecture hall is directly in front of you as you exit the elevator.

Note: The elevator is slightly recessed from the main area.

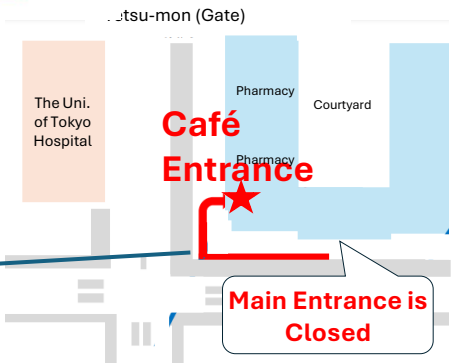

# Program

The abstract will be posted on the website.

**[IMPORTANT: START TIME CHANGE] SATURDAY, 12 OCTOBER 2024**  
**Track A & C will start from 9:10**

	Venue S <Room 2>	Venue T	Venue S <Room 2>	Venue Y <Room 1>
08:00-17:00	<b>TRACK A: Database Pharmacoepidemiology (English)</b> (Introductory/Intermediate)	<b>TRACK B: Database Pharmacoepidemiology (Japanese)</b> (Introductory/Intermediate)	<b>TRACK C: Non - Database Pharmacoepidemiology (English)</b> (Introductory/Intermediate)	<b>TRACK D: Advanced Pharmacoepidemiology (English)</b>
18:15-19:15				<b>100. Plenary Session 1: Recent development of case-only studies in AsiaPacific region</b> <b>Keynote speaker</b> <i>How to detect and remove biases specific to case-crossover studies!</i> Dr Kiyoshi Kubota, NPO Drug Safety Research Unit <b>Co-presenter:</b> <i>Self-controlled case series: the best thing since sliced bread?</i> A/Prof Angel Wong, London School of Hygiene and tropical Medicine
19:30-21:00	<b>ACPE16 Welcome Reception (Venue Ito)</b>			

## SUNDAY, 13 OCTOBER 2024

	Venue Y <Room 1>	Venue S <Room 2>	Venue Ito <Room 3>	Venue M1 <Room 4>
08:30-9:00	<b>Welcome message</b>			
09:00-10:00	<b>200. Conference Opening and Keynote Presentation</b> <b>Keynote speaker:</b> <i>Causal estimands: Should we ask different causal questions in randomized trials and in the observational studies that emulate them?</i> Miguel Hernan, CAUSALab			
10:00-10:30	<b>Morning break and Poster blitz</b>			
10:30-12:00	<b>[SY1. Symposium 1]</b> <b>Navigating Oncology Real-World Data Landscape in Asia Pacific Region: Access, Collaboration, and Future Directions for Enhanced Utilization</b>  <b>Session Chair:</b> Lei Chen, Merck Sharp&Dohme Benjamin Daniels, UNSW Sydney  <b>Speakers:</b> • Dr Kiyoshi Kubota, NPO Drug Safety research Unit • Edward Chia-Cheng Lai, Institute of Clinical Pharmacy & Pharmaceutical Sciences • Wonne Lee, IQVIA Solutions Asia	<b>[SY2. Symposium 2]</b> <b>Leveraging Electronic Health Records in Japan pharmaceutical industry: current status, issues, futures</b>  <b>Session Chair:</b> Takayuki Imaeda, Pfizer Chieko Ishiguro, National Center for Global Health and Medicine  <b>Speakers:</b> • Kanae Togo, Pfizer • Yasunari Sadatsuki, Bayer Yakuhin • Seitaro Yoshida, Chungai Pharmaceutical Co Ltd • Takayuki Imaeda, Pfizer	<b>[SY3. Symposium 3]</b> <b>Deprescription Dynamics: Insights and Strategies for Optimizing Medication Management in Diverse Healthcare Landscapes</b>  <b>Session Chair:</b> Frank May, ISPE Krishna Undela, NIPER Guwahati  <b>Speakers:</b> • Amal Anand, Rutgers University • Atiqulla Shariff, JSS College of Pharmacy, JSS AHER, Mysuru • Shilpa Palaksha, JSS College of Pharmacy, JSS AHER, Mysuru Dr Jsha Myalil Lucca, Gulf Medical University	<b>[SY4. Symposium 4]</b> <b>Evaluation of vaccination policy</b>  <b>Session Chair:</b> Jenni Iiomaki, Monash University Geoge Okoli, The University of Hong Kong  <b>Speakers:</b> • Dr George Okoli, The University of Hong Kong • Prof Simon Bell, Monash University • Dr Grace Wangge, Monash University, Indonesia • A/Prof Ching-Lan Cheng, National Chen Kung University
12:00-13:00	<b>Lunch break and Poster blitz</b>			
	<b>Spotlight poster session</b>			
13:00-14:30	<b>Concurrent Contributed Papers [ Methods]</b>	<b>Concurrent Contributed Papers [ COPD / Asthma]</b>	<b>Concurrent Contributed Papers [ Cardiovascular 1]</b>	<b>Concurrent Contributed Papers [Infectious Disease &amp; Antibiotics]</b>
13:00-13:15	<b>O100. Research status of applying common data model in pharmacoepidemiology: a systematic review</b> Meng Zhang, Peking University	<b>O106. Comparative Cardiovascular Safety of Fixed-dose Combinations of LABA/LAMA/ICS versus LABA/ICS in COPD</b> Marie Jen-Huey Lu, Department of Pharmacy, College of Pharmaceutical Sciences, National Yang Ming Chiao Tung University, Taipei, Taiwan	<b>O112. Validating a Cox-Regression Model to Predict Mortality in HFREF Patients Using Real-World-Data</b> Dr. Yasmin Elsobky, ALNAS Hospital	<b>O118. Risk of macrolides and fluoroquinolones on fatal arrhythmia: a nested case-control study</b> Reo Shibata, Yokohama City University
13:15-13:30	<b>O101. The utility of event-specific methods in causality assessment of drug-adverse reaction</b> Dr Miki Ohta, Clinical Research Promotion Center	<b>O107. Cost-effectiveness of triple therapy compared to dual therapy in chronic obstructive pulmonary disease: A systematic review and meta-analysis</b> Keerthi Raj, National Institute of Pharmaceutical Education and research (NIPER), Guwahati	<b>O113. Superior Effectiveness of Prasugrel over Ticagrelor in Individuals with Acute Coronary Syndrome</b> MD Nils Krüger, Harvard Medical School	<b>O119. Antibiotic De-escalation via the use of Novel Metric among Cancer Patients: A DASC-based Approach</b> Deepthi Avvaru, Kasturba Medical College

	Venue Y <Room 1>	Venue S <Room 2>	Venue Ito <Room 3>	Venue M1 <Room 4>
13:30-13:45	<b>O102. Performance of Matching with Oversample and Replacement Strategy for Imbalanced Real-world Dataset</b> Dr Tanya Pannoi, School of Pharmacy, Walailak University, Thailand	<b>O108. Comparative effectiveness of inhaled corticosteroid in combination therapy for patients with chronic obstructive-pulmonary-disease</b> XiaoYan Ni, Southeast University	<b>O114. Aspirin versus clopidogrel on incident type 2 diabetes in patients with CVD</b> Ms Xi Xiong, The University of Hong Kong	<b>O120. Clinical and Economic Impact of Clinical Pharmacist-Steered Handshake Antibiotic Stewardship in Surgery</b> Dr Ann Vazhayil Kuruvilla JSS College of Pharmacy, Mysuru, JSS Academy of Higher Education and Research
13:45-14:00	<b>O103. Evaluation of Logistic Regression Model for Analyzing Pooled Observational Epidemiological Databases</b> Dr Md Jamal Uddin, Faculty Shahjalal University of Science and Technology	<b>O109. Combination of Chinese and western medications among chronic obstructive pulmonary disease patients</b> Ming-Chia Lee, New Taipei City Hospital	<b>O115. Potential interactions between digoxin and direct oral anticoagulants: cohort &amp; case-crossover designs</b> A/Prof Angel Wong, London School of Hygiene and Tropical Medicine	<b>O121. Prevalence of MALDI-TOF MS for patients with bacteremia using Japanese administrative claims database from FY 2018 to 2020</b> Tomokazu Shoji, University of Yamanashi
14:00-14:15	<b>O104. Synchronization of time zero in pharmacoepidemiology studies using target trial emulation approach</b> Dr Tengfei Lin, Shenzhen Institute of Advanced Technology, Chinese Academy of Sciences	<b>O110. Trends of pneumococcal vaccination coverage among U.S. chronic obstructive pulmonary disease populations</b> Yan-Ning Zeng, School of pharmacy, College of Pharmacy, Taipei Medical University	<b>O116. Anticoagulant Discontinuation After Minor Bleed and Stroke Risk Among Atrial Fibrillation Patients</b> Shiori Nishimura, The University of Tokyo Graduate School of Medicine	<b>O122. Effectiveness of nirmatrelvir/ritonavir and molnupiravir in non-hospitalized adults with COVID-19: systematic review</b> Prof Joseph Blais, The University of Hong Kong
14:15-14:30	<b>O105. Baseline Adjustment to Compare Post-marketing Surveillance Study and Randomized Clinical Trial</b> Richuan Zheng, Janssen Pharmaceutical K.K.	<b>O111. Antidiabetic agents and asthma exacerbation in patients with asthma and diabetes</b> Yi Chen Liao, National Cheng Kung University	<b>O117. Fish oil supplementation, Life's Essential 8, and cardiovascular mortality in diabetic patients</b> Rong Hua, The Chinese University of Hong Kong	<b>O123. Risk factors for S.aureus and MRSA carriage in children: a case-control study</b> Tsz Ying Natalie Tsie, The University of Hong Kong
14:45-16:15	<b>[SY5. Symposium 5]</b> Use of Real-world data for regulatory decision making: the value of collaborations  <b>Session Chair:</b> Helga Gardarsdottir, Utrecht University Olaf Klungel, Utrecht University  <b>Speakers:</b> • Helga Gardarsdottir, Utrecht University • Olaf Klungel, Utrecht University • Edward Chia-Cheng Lai, Institute of Clinical Pharmacy & Pharmaceutical Sciences • A/Prof Kristian Filion, McGill University • A/Prof Ju-Young Shin, Sungkyunkwan University (SKKU) • Prof Kenneth Man, University College London	<b>[SY6. Symposium 6]</b> Student Initiatives in Training of Newcomers in Pharmacoepidemiology in Non-native English-speaking Countries  <b>Session Chair:</b> Yunha Noh, McGill University Chin Yao Shen, Institute of Clinical Pharmacy and Pharmaceutical Sciences, College of Medicine, National Cheng Kung University  <b>Speakers:</b> • Min Fan, University of Hong Kong • Daniel Hsiang-Te Tsai, National Cheng Kung University • Shiori Nishimura, The University of Tokyo Graduate School of Medicine • Mita Restinia, National Cheng Kung University	<b>[SY7. Symposium 7]</b> Government-Industry-Academia Collaboration in Postmarket Outcome Validation Studies in the Era of Real-World Data: Design Considerations, Challenges and Future Opportunities  <b>Session Chair:</b> Kazuto Nomura, Pfizer Soko Setoguchi, Rutgers University  <b>Speakers:</b> • Prof Naoki Nakashima, Kyushu University • Kensuke Kataoka, Tosei General Hospital • Mari Matsui, Pfizer R&D Japan • Dr Yujing Huang, Eli Lilly and Company • Hotaka Maruyama, Pharmaceuticals and Medical Devices Agency	<b>[SY8. Symposium 8]</b> Real-world data in Japan, overview and examples: JSPE Medical and healthcare database utilization committee  <b>Session Chair:</b> Akihiro Nakajima, Teijin Pharma Limited Kanae Togo, Pfizer  <b>Speakers:</b> • Prof Shinobu Imai, Showa University Graduate School of Pharmacy • Akihiro Nakajima, Teijin Pharma Limited • Prof Ryo Watanabe, Kanagawa University of Human Services • Prof Miho Ishimaru, Tokyo Medical and Dental University • Maki Komamine, Office of Pharmacovigilance I, Pharmaceuticals and Medical Devices Agency
16:15-16:45	<b>Afternoon break and Poster blitz</b>			
16:45-18:15	<b>Concurrent Contributed Papers [Diabetes]</b>	<b>Concurrent Contributed Papers [Eyes &amp; Kidney]</b>	<b>Concurrent Contributed Papers [Vaccination]</b>	<b>Concurrent Contributed Papers [Opioids / Signal Detection]</b>
16:45-17:00	<b>O124. SGLT2 Inhibitors and Risk of CKD-MBD in Patients with T2D and CKD</b> Shih-Chieh Shao, Keelung Chang Gung Memorial Hospital	<b>O130. Ophthalmic complications of platinum-based chemotherapy: Insights from disproportionality analysis and systematic review</b> Hasik P.N, National Institute of Pharmaceutical Education and Research (NIPER), Guwahati	<b>O136. Risk of Polymyalgia Rheumatica Following COVID-19 Vaccination in South Korea: SCCS study</b> Hyunbo Lim, Department of Biohealth Regulatory Science, Sungkyunkwan University	<b>O142. High-risk opioid prescribing and persistent opioid use in Australian workers with injuries</b> Mr Yonas Tefera, Monash University
17:00-17:15	<b>O125. Trends in Antidiabetic Medication Use among Patients with Diabetes in the U.S.</b> Yu-Chien Chen, School of Pharmacy, College of Pharmacy, Taipei Medical University	<b>O131. Comparative Effectiveness Between Topical alpha-2 Agonist, Carbonic Anhydrase Inhibitor and Prostaglandin Analog combination therapy for Second-Line Glaucoma Treatment?</b> Avery Shuei-He Yang, Institute of Clinical Pharmacy and Pharmaceutical Sciences, National Cheng-Kung University	<b>O137. Gender Differences in Adverse Events Following COVID-19 Vaccination in South Korea</b> Jeong Ah Kim, Ewha Womans University	<b>O143. Association of benzodiazepines and mortality among patients with non-opioid substance use disorder</b> Brian Li, Institute of Clinical Pharmacy and Pharmaceutical Sciences, College of Medicine, National Cheng Kung University
17:15-17:30	<b>O126. Glycemic Variability and Persistent Acute Kidney Injury: Multicenter Study with External Validation</b> Siyu Kong, China Pharmaceutical University	<b>O132. Comparative Glaucoma Risks Associated with Topiramate and Phenytoin: A Comparative Cohort Study</b> Dr Wan-Ju Annabelle Leem Chi Mei Medical Center	<b>O138. Sequential analysis of COVID-19 vaccine safety in Korea</b> Na-Young Jeong, Ewha Womans University	<b>O144. Prevalence and risk factors of cannabis use after legalization in rural communities</b> Natthaya Chaomuang, University of Phayao

	Venue Y <Room 1>	Venue S <Room 2>	Venue Ito <Room 3>	Venue M1 <Room 4>
17:30-17:45	<b>O127. Comparison of Suicidal-Related Behaviors Between GLP-1RAs and DPP4 Inhibitors in Taiwan</b> Chris Tzu-Ting Su, Institute of Clinical Pharmacy and Pharmaceutical Sciences, College of Medicine, National Cheng Kung University, Taiwan	<b>O133. Glaucoma eye drops and risk of asthma attacks: A target trial emulation</b> Yuto Kono, Yokohama City University	<b>O139. Global burden of vaccine-induced thrombotic thrombocytopenia: analysis of the international pharmacovigilance database</b> Yejun Son, Kyung Hee University College of Medicine	<b>O145. Psychotropic medicine utilisation in Australian workers with back and neck injuries</b> Yonas Tefera, Monash University
17:45-18:00	<b>O128. Comparing cardio-hepatic benefits of GLP1rA and pioglitazone: A target trial emulation study</b> Lanlan Li, University of Hong Kong	<b>O134. Acute Kidney Disease Risk and Postoperative Glycemic Variability After Cardiac Surgery</b> Siyu Kong, China Pharmaceutical University	<b>O140. The risk of acute gastroenteritis following co-administration of rotavirus vaccine</b> Hui-Eon Lee, Ewha Womans University	<b>O146. Regular opioid use of different potency and dementia risk and neuroimaging outcomes</b> Dr Tengfei Lin, Shenzhen Institute of Advanced Technology, Chinese Academy of Sciences
18:00-18:15	<b>O129. Associations between Newer Glucose-Lowering Drugs and Cognitive Impairment in Adults with Diabetes</b> Paopiao Li, University of Florida	<b>O135. Validation of Kidney Failure Risk Equation for Renal Anemia in Asians</b> Yuqing Bao, China Pharmaceutical University	<b>O141. Gastroenteritis hospitalizations before and after rotavirus vaccine: descriptive study using nationwide database</b> Dr Takanori Yanai, Kyoto University Graduate School of Medicine and Public Health	<b>O147. Identifying Safety Signals for Adverse Events Causing Mortality Due to Ferric Carboxymaltose</b> Dr Rathod Mahesh, National institute of pharmaceutical education and research, Guwahati, Assam
19:00-21:00	<b>Social Function/ Conference Dinner (Location: Gakushi Kaikan)</b>			

# MONDAY, 14 OCTOBER 2024

**[IMPORTANT]**  
**VENUE CHANGE**  
 SY10 will be held at  
 South Clinical  
 Research Building (3F)  
 Tetsumon Clinical  
 Lecture Hall

	Venue Y <Room 1>	Venue S <Room 2>	Venue Ito <Room 3>	Venue M1-1F <Room 4>	Venue M1-3F <Room 5>
08:30-10:00	<b>[SY9. Symposium 9]</b> Three approaches to conduct real-world studies across multiple healthcare systems: common research question, common protocol, and common data model	<b>[SY10. Symposium 10]</b> Medical Device Epidemiology in Asia: Examples and Challenges	<b>[SY11. Symposium 11]</b> Early-career pharmacoepidemiologists: perspectives and progress from Asia	Concurrent Contributed Papers [Geriatric]	Concurrent Contributed Papers [Cancer]
08:30-08:45	<b>Session Chair:</b> Chieko Ishiguro, National Center for Global Health and Medicine Chi-chuan Wang, National Taiwan University  <b>Speakers:</b> <ul style="list-style-type: none"> <li>Chin Yao Shen, Institute of Clinical Pharmacy and Pharmaceutical Sciences, College of Medicine, National Cheng Kung University</li> <li>A/Prof Ching Lung Cheung, The University of Hong Kong</li> <li>Jeff Lange, Amgen</li> <li>Hojoon Lee, Amgen Korea</li> <li>Dr Suzu Chia-Hsien Chang, Amgen Japan</li> </ul>	<b>Session Chair:</b> Hiraku Kumamaru, University of Tokyo Mary Ritchey, CERobs Consulting  <b>Speakers:</b> <ul style="list-style-type: none"> <li>Hiraku Kumamaru, University of Tokyo</li> <li>Mary Ritchey, CERobs Consulting</li> <li>Hironobu Tokumasu, Ohara Healthcare Foundation</li> <li>Yongjing Zhang, Global Epidemiology, Johnson &amp; Johnson</li> </ul>	<b>Session Chair:</b> Celine Chui, The University Of Hong Kong Masao Iwagami, University of Tsukuba  <b>Commentator:</b> Jenni Ilomaki, Monash University  <b>Speakers:</b> <ul style="list-style-type: none"> <li>Assit/Prof Toshiki Fukasawa, Kyoto University</li> <li>Na-Young Jeong, Ewha Womans University</li> <li>Assit/Prof Jui Wang, National Taiwan University &amp; National Taiwan University Health Data Research Center</li> <li>Assit/Prof Eric Wan, University of Hong Kong</li> <li>Dr Nhung Trinh, University of Oslo</li> </ul>	<b>O200. Rising Star Awardee</b> <b>Association between Anticholinergic burden and risk of Fall and Fracture: Case-Case-Time-Control Study</b> Albert Tzu-Ming Chuang, Population Health Data Center, National Cheng Kung University	<b>O206. Utility of electronic medical record databases for oncology pharmacoepidemiologic studies in Japan</b> Dr Kiyoshi Kubota, NPO Drug Safety Research Unit Japan
08:45-09:00				<b>O201. Association between Recently Elevated Anticholinergic Burden and Urinary Retention: A Case-case-time-control Study</b> Daniel Hsiang-Te Tsai, National Cheng Kung University	<b>O207. Heavy Metal Contamination in Drinking Water Increases Gallbladder Cancer Risk in India</b> Mr Christy Thomas, National Institute of Pharmaceutical Education and Research (NIPER), Guwahati, Assam, India
09:00-09:15				<b>O202. Associations Between Polypharmacy, Inflammatory Markers and biological aging among US Older Adults</b> Dr Kai Wei, Guizhou Provincial People's Hospital	<b>O208. Treatment patterns and outcomes of EGFR exon20ins mutated NSCLC patients in Taiwan</b> Kai-Cheng Chang, LinKou Chang Gung Memorial Hospital
09:15-09:30				<b>O203. Predicting Long-Term Mortality in Elderly Using Shizuoka Hip Fracture Prognostic Score: SHIPS</b> Emi Ohata, 4DIN Ltd	<b>O209. Risk of lung cancer with concomitant use of ACEi and DPP4i</b> Bin Hong, Sungkyunkwan University
09:30-09:45				<b>O204. Sedative and anticholinergic medication use in older Australians with dementia</b> Dr Edwin Tan, The University of Sydney	<b>O210. Treatment modalities for primary head and neck cancer in Japan</b> Dr Grace Hui-Min Wu, Global Epidemiology, Office of Chief Medical Officer, Johnson & Johnson
09:45-10:00				<b>O205. Calcium Channel Blockers and Selective Serotonin Reuptake Inhibitors Use and Fracture Risk</b> Dr. Haesuk Park, University of Florida	<b>O211. Occurrence of Adverse Drug Reactions in Chemotherapy Patients: A Cross-sectional Study</b> Zuha Shyma, Manipal College of Pharmaceutical Science

	Venue Y <Room 1>	Venue S <Room 2>	Venue Ito <Room 3>	Venue M1-1F <Room 4>	Venue M1-3F <Room 5>
10:00-10:15	<b>Morning break and Poster blitz</b>				
10:15-11:15	<b>300. Plenary Session 3: Translating pharmacoepidemiology research into real-world practice in the Asia-Pacific region</b> <b>Keynote speaker:</b> Yea-Huei Kao, School of Pharmacy, Institute of Clinical Pharmacy and Pharmaceutical Science, College of Medicine, National Cheng Kung				
11:30-13:00	<b>Concurrent Contributed Papers [Cardiovascular 2]</b>	<b>Concurrent Contributed Papers [Cost Effectiveness / Economic Evaluations]</b>	<b>Concurrent Contributed Papers [Prenatal &amp; Pregnancy]</b>	<b>Concurrent Contributed Papers [Cancer &amp; Others]</b>	<b>Concurrent Contributed Papers [Medication Access / Regulation]</b>
11:30-11:45	<b>O212. Disease burden and treatment patterns of atherosclerotic cardiovascular diseases in Hong Kong</b> Yu Yang, The university of Hong Kong	<b>O218. Real-world cost-effectiveness study of first and third generation EGFR-TKIs for advanced NSCLC</b> Dr Avinash Khadela, L. M. College of Pharmacy	<b>O224. Prenatal and infant antibiotic exposure linked to child neuropsychiatric disorder risk</b> Jaeyu Park, Master's course Department of Regulatory Science, Kyung Hee University, Seoul, South Korea	<b>O230. Twenty-year secular trend of thyrotoxicosis and thyrotoxic periodic paralysis in Hong Kong</b> Dr Gloria Hoi-Yee Li, The Hong Kong Polytechnic University	<b>O236. Access to Oral Childhood Cancer Medicines in High Income and LMIC Countries</b> Dr Dima M Qato, University of Southern California
11:45-12:00	<b>O213. Associations of biological aging with intraoperative hypotension during major surgery</b> Xuan Yin, China Pharmaceutical University	<b>O219. Impact of Price Changes on Economic Burden of Anemia Treatment in CKD</b> Yuqing Bao, China Pharmaceutical University	<b>O225. A national population study of preterm birth following COVID-19 vaccination during pregnancy</b> Erdenetuya Bolormaa, Department of Preventive Medicine, Korea University College of Medicine	<b>O231. Effect of Biological Immunotherapy for Psoriasis on the Development of Psoriatic Arthritis</b> Yongtai Cho, Sungkyunkwan University	<b>O237. Access to Monoclonal Antibody and Antibody-Drug Conjugates for Cancer Indication in Indonesia</b> Sudi Indra Jaya, Universitas Gadjah Mada
12:00-12:15	<b>O214. Influenza vaccines reduce hospitalized cardiovascular complications in Taiwan elderly: a nationwide study</b> Zi-Yang Peng, Institute of Clinical Pharmacy and Pharmaceutical Science, College of Medicine, National Cheng Kung University, Tainan	<b>O220. Cost-effectiveness analysis of combinatorial pharmacogenomic-guided treatment for major depression</b> Dina Abushanab, Monash University	<b>O226. Pregnancy Outcomes Following COVID-19 Vaccination: Preterm, Stillbirth and Miscarriage</b> Hee-Jin Kim, Ewha Womans University	<b>O232. Role of Rare Disease Databases in Pharmacoepidemiological Studies in India: A Review</b> Dr Venkatesh MP, JSS College of Pharmacy, Mysuru	<b>O238. Descriptive analysis of outcomes in regulatory-required post-marketing database studies in Japan</b> Hiroshi Yamazaki, Janssen Pharmaceutical K.K.
12:15-12:30	<b>O215. Exploring the cardiometabolic impact of antipsychotics: real-world evidence from Australia</b> Ramya Padmavathy Radha Krishnan, University of Sydney	<b>O221. Productivity Burden of Cardiovascular Disease in Diabetes and Impact of Health Interventions</b> Dina Abushanab, Monash University	<b>O227. Prenatal benzodiazepines or z-drugs use and risk of psychiatric disorders in children</b> Ahhyung Choi, School of Pharmacy, Sungkyunkwan University / Harvard-MIT center for regulatory science, Harvard Medical School	<b>O233. Site-specific Cancer Incidence among Antipsychotic Users in Hong Kong: Descriptive Cohort Study</b> Yuqi Hu, The University of Hong Kong	<b>O239. Prescriptions of the acid-suppressants after withdrawal of ranitidine in Korea</b> Jeong Pil Choi, Seoul National University
12:30-12:45	<b>O216. Trends in the use of sodium-glucose cotransporter 2 inhibitors following hospitalisation with heart failure, New South Wales, Australia</b> Dr Jaling Lin, University of New South Wales	<b>O222. Cost-effectiveness of universal screening for Lynch syndrome among colorectal cancer patients in Vietnam</b> Cong Bang Huynh, University of Medicine and Pharmacy at Ho Chi Minh City	<b>O228. Real-world drug exposure during pregnancy: Insights from the .DIIP database</b> Shinichi Matsuda, RAD-AR Council	<b>O234. Aspirin Use and Mortality Following a Cancer Diagnosis: A Clone-Censoring Weighting Method</b> Avery Shuei-He Yang, Institute of Clinical Pharmacy and Pharmaceutical Sciences, National Cheng-Kung University	<b>O240. Decision-making Autonomy in Healthcare Utilization among Married Women and Associated Factors</b> Dr Sofa Alfian, Universitas Padjadjaran
12:45-13:00	<b>O217. Low-dose versus standard-dose prasugrel in East Asians with acute coronary syndrome: a matching-adjusted indirect comparison using real-world data</b> You-Shin Tsai, National Taiwan University	<b>O223. Assessing Burden of Chronic Diseases on Health-Related Quality of Life in Taiwan</b> Chia-Chen Hung, School of Pharmacy, College of Medicine, National Taiwan University	<b>O229. Assessment of Maternal Dietary Pattern and its effect on Early Gestational Period</b> Chippy Anna Jy, National Institute of Pharmaceutical Education and Research (NIPER), Guwahati, Assam, India	<b>O235. Longevity of systematic reviews of PARP inhibitors in ovarian cancer</b> Varri Naga Gowthami, National institute of pharmaceutical education and research, Guwahati	<b>O241. Mapping five-year changes in childhood immunization in a South Indian community</b> Dr Merrin Mathew, JSS College of Pharmacy, Mysuru



	Venue Y <Room 1>	Venue S <Room 2>	Venue Ito <Room 3>	Venue M1-1F <Room 4>	Venue M1-3F <Room 5>
13:00-14:00	<b>Lunch break and Poster blitz</b>				
<b>Spotlight poster session</b>					
14:00-15:30	<p><b>[SY12. Symposium 12]</b> Leveraging regulatory pharmacoepidemiology for informed decision making in Asia</p> <p><b>Session Chair:</b> Hisashi Urushihara, Keio University Yoshiaki Uyama, Pharmaceuticals and Medical Devices Agency</p> <p><b>Speakers:</b></p> <ul style="list-style-type: none"> <li>In-sook Park, Korea Regulatory Science Centre</li> <li>Lih-juan Hsu, Center for Drug Evaluation</li> <li>Yoshiaki Uyama, Pharmaceuticals and Medical Devices Agency</li> <li>Kazuhiro Kajiyama, Pharmaceuticals and Medical Devices Agency</li> </ul>	<p><b>[SY13. Symposium 13]</b> From Asia to the World – Engaging in the ISPE Strategic Plan 2024-2029</p> <p><b>Session Chair:</b> Dr Mary Ritchey, CERobs Consulting</p> <p><b>Speakers:</b></p> <ul style="list-style-type: none"> <li>Dr Mary Ritchey, CERobs Consulting</li> <li>Prof Yea-Huei Kao, School of Pharmacy, Institute of Clinical Pharmacy and Pharmaceutical Science, College of Medicine, National Cheng Kung University</li> <li>Dr Hiraku Kumamaru, University of Tokyo</li> </ul>	<p><b>[SY14. Symposium 14]</b> Climate Change and Pharmacoepidemiology in Asia</p> <p><b>Session Chair:</b> Benjamin Bates, Rutgers University</p> <p><b>Speakers:</b></p> <ul style="list-style-type: none"> <li>Prof Masahiro Hashizume, University of Tokyo</li> <li>Dr Soko Setoguchi, Rutgers University</li> <li>A/Prof Harish C. Phuleria, Indian Institute of Technology Bombay</li> <li>Dr Benjamin Bates, Rutgers University</li> <li>Dr Shu Ping Huang, Changhua Christian Hospital</li> </ul>	<p><b>[SY15. Symposium 15]</b> From Blueprint to Reality: Development, Conversion, and Application in the Common Data Model Approach Among Asia-Pacific Databases</p> <p><b>Session Chair:</b> Suzu Chia-Hsien Chang, Amgen Japan Edward Chia-Cheng Lai, School of Pharmacy, Institute of Clinical Pharmacy and Pharmaceutical Sciences</p> <p><b>Speakers:</b></p> <ul style="list-style-type: none"> <li>Brian Li, Institute of Clinical Pharmacy and Pharmaceutical Sciences, College of Medicine, National Cheng Kung University</li> <li>Chin Yao Shen, Institute of Clinical Pharmacy and Pharmaceutical Sciences, College of Medicine, National Cheng Kung University</li> <li>Assist/Prof Celine Sze Ling Chui, School of Nursing and School of Public Health</li> <li>Bin Hong, Sungkyunkwan University</li> <li>Hsun Yin Liang, Taiwan Drug Relief Foundation</li> </ul>	<p><b>[SY16. Symposium 16]</b> Maternal and perinatal health studies using Real-World Data</p> <p><b>Session Chair:</b> Prof Kenneth Man, University College London Dr Adrienne Chan, The University of Hong Kong</p> <p><b>Speakers:</b></p> <ul style="list-style-type: none"> <li>Prof Kenneth Man, University College London</li> <li>Dr Adrienne Chan, The University of Hong Kong</li> <li>A/Prof Ju-Young Shin, Sungkyunkwan University (SKKU)</li> <li>Avery Shuei-He Yang, Institute of Clinical Pharmacy and Pharmaceutical Sciences, National Cheng-Kung University</li> </ul>
15:30-16:00	<b>Afternoon break and Poster blitz</b>				
16:00-17:30	Concurrent Contributed Papers [Machine Learning/ AI & Vaccinator]	Concurrent Contributed Papers [Molecular & Covid – 19]	Concurrent Contributed Papers [Medication Adherence]	Concurrent Contributed Papers [Psychiatric]	Concurrent Contributed Papers [Cancer - Breast & Prostate]
16:00-16:15	<b>O242. Machine learning for high-risk multimorbid antipsychotic user identification and cardiovascular event prediction</b> Qi Sun, The University of Hong Kong	<b>O248. Association of vitamin D Status with various biomarkers in diabetic foot infection</b> Ruby Benson, Manipal College of Pharmaceutical Sciences, Manipal Academy of Higher Education (MAHE), Manipal	<b>O254. Development of Novel Medication Adherence Scale for Chronic Diseases Patients In Indonesia</b> Qisty Aulia Khoiry, Universitas Padjadjaran	<b>O260. Rising Star Awardee The use of ADHD medication and the risk of suicide attempt</b> Dr Adrienne Chan, The University of Hong Kong	<b>O266. Dihydropyrimidine dehydrogenase deficiency genotyping-guided fluoropyrimidine-based adjuvant chemotherapy for breast cancer. Cost-effectiveness analysis</b> Dina Abushanab, Monash University
16:15-16:30	<b>O243. Artificial Intelligence Techniques for the Survival Prediction of Oropharyngeal Squamous Cell Carcinoma</b> Dr Krishna Undela, National Institute of Pharmaceutical Education and Research (NIPER) Guwahati	<b>O249. Nationwide Cross Sectional Study for Local Polypharmacy by NDB data during COVID-19</b> Dr Takehiro Ishida, Teikyo University School of Public Health	<b>O255. Association between coordinated care and adherence to antihypertensive medicines among adults experiencing polypharmacy in Australia</b> Dr Jaling Lin, University of New South Wales	<b>O261. Evidence base for off-label use of psychotropic medications in adolescents with depression</b> Dr Menghuan Song, University of Macau, Institute of Chinese Medical Sciences	<b>O267. Risk of endometrial cancer by endocrine therapy for breast cancer in Japan</b> Dr Chitose Kawamura M.D., University of Tsukuba
16:30-16:45	<b>O244. Computational drug repurposing for gallbladder cancer integrated with pharmacovigilance approach</b> Vismitha Varghese, National Institute of Pharmaceutical Education and Research (NIPER) Guwahati	<b>O250. WITHDRAWN</b>	<b>O256. Assessment of Medication Adherence and The Impact of Patient Education on Medication Adherence Among Polycystic Ovarian Syndrome Patients</b> Shilpa Clara Joseph, JSS College of Pharmacy, Mysuru	<b>O262. Suicidality and vortioxetine in adolescents and young adults: disproportionality analysis using FAERS</b> Dr Nhung Trinh, University of Oslo	<b>O268. Cardiotoxicity in postmenopausal breast cancer: a comparison of aromatase inhibitors and tamoxifen</b> Shu-Chen Hu, Graduate Institute of Clinical Pharmacy, College of Medicine, National Taiwan University
16:45-17:00	<b>O245. AI in Pharmacovigilance: Asia Pacific's Scientific and Public Discourse</b> Dr Grace Wangge, Monash University, Indonesia	<b>O251. Metformin's impact on post-COVID-19 condition risk in overweight/obese individuals in the UK</b> Ubonphan Chaichana, UCL School of Pharmacy	<b>O257. Patterns of medication adherence to lipid-lowering therapy in primary care</b> Caroline Trin, Monash University	<b>O263. Self-harm and the use of leukotriene receptor antagonists and inhaled corticosteroids</b> Boqing Chen, School of Pharmacy, University College London	<b>O269. Cardiovascular Risks in Prostate Cancer Patients Using Adjunct Treatment</b> Tung Hiu Li, The University Of Hong Kong
17:00-17:15	<b>O246. Risk of Guillain-Barre syndrome after Influenza Vaccination in Korean Adults</b> Haerin Cho, Ewha Womans University	<b>O252. Effectiveness of Molnupiravir and Nirmatrelvir-Ritonavir in COVID-19 Patients with Type-2 Diabetes</b> Zoey CT Wong, The University of Hong Kong	<b>O258. Impact of Same-Day ART on Care and Medication Discontinuation Among HIV/AIDS Patients</b> Hsiao-Juu Yu, National Yang Ming Chiao Tung University	<b>O264. Association of hydroxychloroquine and psychiatric disorders among patients with systemic lupus erythematosus</b> Brian Li, Institute of Clinical Pharmacy and Pharmaceutical Sciences, College of Medicine, National Cheng Kung University	<b>O270. Primary Prevention of Hormonal Treatment-related Cardiovascular Events in High-Risk Prostate Cancer Patients</b> Tung Hiu Li, The University Of Hong Kong
17:15-17:30	<b>O247. Trends and predictors of zoster vaccination coverage among U.S. cardiovascular disease population</b> Chieh Yu Ho, School of Pharmacy, College of Pharmacy, Taipei Medical University	<b>O253. Irrational Consumption of Ivermectin During the COVID-19 Pandemic: Data From 67 Countries</b> Daniel Hsiang-Te Tsai, National Cheng Kung University	<b>O259. Development and pre-validation of the medication treatment satisfaction instrument for children and adolescents aged 8-18 years old</b> Mengting Yang, West China Second University Hospital, Sichuan University	<b>O265. Medication Treatment Patterns for Attention-Deficit/Hyperactivity Disorder in Chinese Children and Adolescents</b> Si Chen, China Pharmaceutical University	<b>O271. Incidence of type 2 diabetes mellitus in men initiated tadalafil</b> Dr Atsushi Takayama, Kyoto University
17:30-18:00	<b>Awards Presentation and Closing Plenary</b>				



## Educational Session Program Saturday 12 October 2024

### TRACK A: DATABASE PHARMACOEPIDEMIOLOGY

(Introductory/Intermediate) (English)

**Venue: Sanjo Kaikan Large Lecture Room (2<sup>nd</sup> Floor)**

**Organizers: Edward Lai and Sallie Pearson**

Time	Topic
09:10 (30 mins)	<b>Designing pharmacoepidemiologic studies from clinical questions</b> <b>Instructor:</b> Esther WY Chan, Hong Kong University
09:40 (90 mins)	<b>Principles of pharmacoepidemiology using large databases</b> <i>Use of healthcare databases for pharmacoepidemiology research</i> <b>Instructor:</b> Juliana de Oliveira Costa, UNSW <i>Cohort study design and estimating drug exposure within healthcare databases</i> <b>Instructor:</b> Michael Falster, UNSW
11:10 (30 mins)	<b>BREAK</b>
11:40 (90 mins)	<b>Evaluation of clinical outcomes in healthcare databases</b> <i>Evaluation of clinical outcomes in healthcare databases</i> <b>Instructor:</b> Shirley Li, Hong Kong University <i>Bias and confounding</i> <b>Instructor:</b> Celine Sze Ling Chui <i>Thought exercise using healthcare databases to answer a clinical question</i> <b>Instructor:</b> Shirley Li and Celine Sze Ling Chui
13:10 (60 mins)	<b>LUNCH on your own</b>
14:10 (90 min)	<b>Practical skills in protocol writing and statistical analytic programming in pharmacoepidemiology- From Research Question to Protocol</b> <b>Instructor:</b> Ben Daniels, UNSW
15:40 (30 mins)	<b>BREAK</b>
16:10 (80 mins)	<b>Practical skills in protocol writing and statistical analytic programming in pharmacoepidemiology – From Protocol to SAS Programming</b> <b>Instructors:</b> Steven Chin-Yao Shen and Albert Tzu-Ming Chuang, NCKU
17:30	<b>CLOSE</b>



## Educational Session Program Saturday 12 October 2024

### TRACK B: DATABASE PHARMACOEPIDEMIOLOGY

(Introductory/Intermediate) (Japanese)

Venue: Takeda Auditorium

Organizers: Yoshinori Takeuchi, Masao Iwagami

Time	Topic
<b>Morning Session: Fundamentals of Pharmacoepidemiology</b>	
08:30 (60 mins)	<b>Selection of medical information databases</b> <b>Instructor:</b> Yasunari Sadatsuki, Bayer Yakuhin, Ltd.
9:30 (15 mins)	<b>BREAK</b>
09:45 (60 mins)	<b>Common study designs in pharmacoepidemiology studies</b> <b>Instructor:</b> Wataru Mimura, National Center for Global Health and Medicine
10:45 (15 mins)	<b>BREAK</b>
11:00 (60 mins)	<b>Common biases in pharmacoepidemiology</b> <b>Instructor:</b> Motohiko Adomi, Harvard University
12:00 (60 mins)	<b>LUNCH on your own</b>
<b>Afternoon Session: Misconceptions in Commonly Used methodologies in Pharmacoepidemiology</b>	
13:00 (10 mins)	<b>Introduction to the afternoon session</b> <b>Speaker:</b> Masao Iwagami, Tsukuba University
13:10 (60 mins)	<b>Causal interpretation of hazard ratio</b> <b>Instructor:</b> Tomohiro Shinozaki, Tokyo University of Science
14:10 (60 mins)	<b>Time-varying treatment and confounder</b> <b>Instructor:</b> Yasuhiro Hagiwara, The University of Tokyo
15:10 (20 mins)	<b>BREAK</b>
15:30 (60 mins)	<b>Causal inference based on self-controlled study designs</b> <b>Instructor:</b> Yoshinori Takeuchi, Yokohama City University
16:30 (60 mins)	<b>Missing data analyses</b> <b>Instructor:</b> Aya Kuchiba, Teikyo University
17:30	<b>CLOSE</b>



## Educational Session Program Saturday 12 October 2024

### TRACK C: NON-DATABASE PHARMACOEPIDEMOLOGY

(Introductory/Intermediate) (English)

Venue: Sanjo Kaikan Meeting Room 01 (1<sup>st</sup> Floor)

**Organizers: Krishna Undela, Kai-Li Liaw**

Time	Topic
09:10 (20 mins)	<b>Designing pharmacoepidemiologic studies from clinical questions</b> <b>Instructor:</b> Kai-Li Liaw, Merck
09:30 (90 mins)	<b>Principles of descriptive pharmacoepidemiologic study designs</b> <b>Instructor:</b> Krishna Undela, National Institute of Pharmaceutical Education and Research
11:00 (15 mins)	<b>BREAK</b>
11:15 (90 mins)	<b>Principles of analytic pharmacoepidemiologic study designs</b> <b>Instructor:</b> Kai-Li Liaw
12:45 (60 mins)	<b>LUNCH on your own</b>
13:45 (30 mins)	<b>Structure of a non-database pharmacoepidemiologic study protocol</b> <b>Instructor:</b> Kai-Li Liaw
14:15 (75 mins)	<b>Protocol writing for a non-database pharmacoepidemiologic studies: hands-on experience</b> <b>Instructors:</b> Kai-Li Liaw and Krishna Undela
15:30 (15 mins)	<b>BREAK</b>
15:45 (60 mins)	<b>Statistical analytic programming relevant to non-database pharmacoepidemiology</b> <b>Instructor:</b> Krishna Undela
16:45 (60 mins)	<b>Critical appraisal of a non-database pharmacoepidemiologic study article</b> <b>Instructor:</b> Krishna Undela and Kai-Li Liaw
17:45	<b>CLOSE</b>



## Educational Session Program Saturday 12 October 2024

### TRACK D: ADVANCED PHARMACOEPIDEMIOLOGY

(English)

Venue: Yasuda Auditorium

Time	Topic
08:30 (90 mins)	<b>PE guidance in transparency, and reproducibility in Europe, US and Asia</b> <b>Instructor:</b> Olaf Klungel, Utrecht University, Helga Gardarsdottir, Utrecht University
10:00 (30 mins)	<b>BREAK</b>
10:30 (90 mins)	<b>Methods for Validation Study for clinical endpoints</b> <b>Organizer:</b> Takuhiro Yamaguchi, Tohoku University <b>Instructors:</b> Masao Iwagami, Tsukuba University, Masataka Taguri, Tokyo Medical University, Kentaro Sakamaki, Juntendo University, Takuya Kawahara, The University of Tokyo
12:00 (60 mins)	<b>LUNCH on your own</b>
13:00 (90 mins)	<b>Advanced topics for the target trial emulation</b> <b>Instructors:</b> Edward Lai, National Cheng Kung University Kenneth Man, UCL School of Pharmacy Joshua Lin, Harvard Medical School
14:30 (30 mins)	<b>BREAK</b>
15:00 (60 mins)	<b>Prevalent New User Design: Considerations, Challenges, and Opportunities</b> <b>Instructor:</b> Kristian B Filion, McGill University
16:00 (20 mins)	<b>BREAK</b>
16:20 (70 mins)	<b>Methods in Environmental Pharmacoepidemiology</b> <b>Instructors:</b> Benjamin Bates, Rutgers University Harish Phuleria, Indian Institute of Technology Bombay Soko Setoguchi, Rutgers University
17:30	<b>CLOSE</b>

# Spotlight Poster Program

Sunday, 13 October 2024

SP500-SP507: Venue Ito B1F Gallery 1/SP508-SP514: Venue Ito B2F

Poster Board	Paper Title	Title	First Name	Last Name	Organization
SP500	Optimizing Depression Treatment: A Cost-Effectiveness Analysis of Pharmacogenetic-Guided Therapy in Qatar	Prof	Daoud	Al-Badriyeh	Qatar University
SP501	Exploring Glucocorticoid Receptor Expression in Type 2 Diabetes Mellitus Sepsis Patients	Dr	Gestina	Aliska	Faculty of Medicine, Universitas Andalas
SP503	Comparison of machine learning models on cardiovascular risk prediction in diabetic patients		Kiyoshi	Minematsu	EPS Corporation
SP504	Long term Comparative Safety of ARNI verses ACEi/ARB: A Real-World Data analysis	Dr	Yasmin	Elsobky	ALNAS Hospital
SP505	Antibiotic use in Singapore pre- and post-COVID-19: a quasi-experimental approach		Shi Thong	Heng	MOH
SP506	Association between SGLT2 inhibitor exposure and risk of gastroesophageal reflux disease		Ting Yu	Jian	Graduate Institute of Clinical Pharmacy, College of Medicine, National Taiwan University
SP507	Association Between Metabolic Syndrome And Chronic Periodontitis in Japanese Claims Database		Makoto	KANENISHI	Ark Medical Solutions Inc.
SP508	Treatment Patterns of Patients with Rheumatoid Arthritis in Japanese Claims Database		Masaru	Koyama	Ark Medical Solutions Inc.
SP509	Drug Utilization Pattern of Anticholinergic Drugs among Patients with Dementia in Taiwan		Yu-Hsuan	Kuo	School of Pharmacy, College of Pharmacy, Taipei Medical University
SP510	Reassessment and update of the Japanese Treatment Satisfaction Questionnaire for Medication (TSQM)		Anzu	Yakushiji	IQVIA Solutions Japan G.K.
SP511	Myasthenia gravis following initiation of statin therapy: multinational self-controlled case series study		Vincent Ka Chun	Yan	The University of Hong Kong
SP512	Association between SGLT-2 inhibitors and DPP4-inhibitors Use and Risk of Acute Pancreatitis	Dr	Ye-Jee	Kim	Asan Medical Center
SP513	Effectiveness and Safety of First-line Chemotherapy in Elderly Metastatic Pancreatic Cancer Patients		Chin-Wei	Hsu	Chi Mei Medical Center
SP514	Gender Differences in Safety of Polypharmacy in Korean Elderly		Heehyun	Won	Department of Health Convergence, College of Science and Industry Convergence

Monday, 14 October 2024

SP515-SP521: Venue Ito B1F Gallery 1/SP522-SP529: Venue Ito B2F

Poster Board	Paper Title	Title	First Name	Last Name	Organization
SP515	Performance status classification of lung cancer patients by trained machine learning		Shunsuke	Takada	Daiichi Sankyo Co., Ltd.
SP516	Comparative Effectiveness of Levetiracetam versus Valproic Acid in Post-Stroke Seizure Patients	A/Prof.	Chi-chuan	Wang	National Taiwan University
SP517	Identification of Hypocalcemia Prognostic Factors with Romosozumab Administration: A Nested Case-Control Study		Hui-Ni	Huang	LinKou Chang Gung Memorial Hospital
SP518	Lithium and risk of fractures in bipolar disorder: A Population-Based Cohort Study	Dr	Vanessa W.S.	Ng	The University of Hong Kong
SP519	Comparative effectiveness of long-acting injectable versus oral antipsychotics in patients with schizophrenia	Dr	Yusuke	Okada	Keio University
SP520	Quantification and Related Factors of Oversupply of Chronic Disease Medications in Japan.		Junko	Tomida	Tokushima Bunri University
SP521	Telomere length, a marker of aging, based on nutritional status in women	Dr	Desmawati	Desmawati	Universitas Andalas
SP522	Validation of claims-based algorithms for intussusception in Japan: The CLEAR Study	Dr	Chieko	Ishiguro	National Center for Global Health and Medicine
SP523	A Prediction Model for the 5-ASA Intolerance among Japanese ulcerative colitis patients		Kazuto	Koshiro	Department of Biostatistics, Graduate School of Medical Science, Kyoto Prefectural University of Medicine
SP524	Erythropoiesis-stimulating agents and osteoporotic fracture in chronic kidney disease: A case-control study		Suhas	Krishnamoorthy	The University of Hong Kong
SP525	Exploring Signals of Substance Use Disorder Using VigiBase		Ji Won	Lee	College of Pharmacy and Department of Global Innovative Drugs, Chung-Ang University, Seoul, Korea
SP526	Pharmacoepidemiology of Tuberculosis Preventive Therapy in HIV Programs in Nigeria: Lessons Learned		Ozioma	Onokala	AIDS Healthcare Foundation Nigeria
SP527	Antibiotic utilization in infective endocarditis management at a teaching hospital in Vietnam		Thi Lan Nhi	VU	University Medical Center Ho Chi Minh City
SP528	Von Hippel-Lindau disease-associated renal cell carcinoma natural history study in China	Dr	Jahuang	Lin	MSD R&D China
SP529	Efficacy and safety of parpi as 1l-maintenance therapy in aoc: network meta-analysis		Saurabh	Wadghule	National Institute of Pharmaceutical Education and Research (NIPER) Guwahati

P: Poster / O: Oral / SP: Spotlight Poster

# Poster Program

Sunday, 13 October 2024

ADHERENCE						Venue E2
Poster Board	Paper Title	Title	First Name	Last Name	Organization	
P100	Adherence Trajectories to Aromatase Inhibitors in Postmenopausal Breast Cancer: A Five-Year Study		Wen-Li	Kuan	National Taiwan University	
P101	ART Adherence and its Associated Barrier Experienced by PLHIV in Mizoram, India.		Irene	Lalhruaimawii	Manipal College of Pharmaceutical Sciences	
P102	Clinical Pharmacist's Intervention to Improve Medication Adherence in Patients Receiving Oral Oncolytics	Dr	Krishna	Undela	National Institute of Pharmaceutical Education and Research (NIPER) Guwahati	
P103	Development and validation of medication adherence questionnaire for patients with chronic illnesses in Southern India		Jeslin Theres	Thomas	JSS College of Pharmacy, Mysuru	
P104	Impact of CPE program on medication adherence among community pharmacists		Jennifer	James	JSS College of Pharmacy, Mysuru	
P105	Knowledge, medication beliefs and adherence in diabetes patients: A structural equation modelling		Indriastuti	Cahyaningsih	Universitas Muhammadiyah Yogyakarta	
P106	Real-world persistence with second-line IL-17i and IL-23i treatment for psoriasis in Japan		Tong	Li	Global Epidemiology, Janssen Research & Development, LLC	
P107	Statin Medication Adherence in Relation to Dyslipidemia Risk Categories		Kenji	Momo	Showa University	

AI AND MACHINE LEARNING						Venue E2
Poster Board	Paper Title	Title	First Name	Last Name	Organization	
P108	Comparative evaluation of generative large language models in adverse drug reaction prediction		Yen Ling	Koon	Health Sciences Authority	
P109	ePhenotyping: machine learning approach for defining diabetic kidney disease as an outcome		Shinsuke	Ohnuki	EPS Corporation	
P110	Investigating NAFLD Patient Phenotypes in Southern Taiwan Using Machine Learning-based Cluster Analysis		Chuan-Wei	Shen	School of Pharmacy, Kaohsiung Medical University	
P111	Machine learning predicting risk of infection among patients treated with b/ts DMARDs		Kuan	Peng	University of Hong Kong	

ASTHMA AND COPD						Venue E2
Poster Board	Paper Title	Title	First Name	Last Name	Organization	
P112	Development of pulsatile drug delivery system of Bambuterol for treatment of Asthma		SANJAY	J	JSS College of Pharmacy, JSS Academy of higher education and research, Mysuru, India	
P113	Reliever use and asthma control among U.S. adults with asthma, 2007-2020	Dr	Chun-Tse	Hung	Taipei Medical University	
P114	Trends in Use of Asthma Inhalers with High Global Warming Potential	Dr	Dima M	Qato	University of Southern California	

AUTOIMMUNE						Venue E2
Poster Board	Paper Title	Title	First Name	Last Name	Organization	
P115	Belimumab utilization evaluation at a tertiary hospital in Taiwan		Yen-Hao	Liao	Linkou Chang Gung Memorial Hospital	
P116	Efficacy of telitaccept in the treatment of SLE: a network meta-analysis		Xintong	He	IQVIA	
P117	Forecasting the incidence and prevalence of inflammatory bowel disease in three countries		Qiwen	Fang	The University of Hong Kong	
P118	Interaction of Disease Modifying Anti Rheumatoid Drugs in A Public District Hospital	Dr	Mohammad	Bakhriansyah	Faculty of Medicine and Health Sciences, Universitas Lambung Mangkurat	

CARDIOVASCULAR						Venue E2
Poster Board	Paper Title	Title	First Name	Last Name	Organization	
P119	Aspirin for Prophylaxis of VTE: Systematic Review and Meta-analysis of Non-Randomized Studies		Raghava Kalyan	Maddukuri	Chebrolu Hanumaiah Institute of Pharmaceutical Sciences	
P120	Association between antihypertensive types and hospital stay and mortality in stroke patients		Alfi	Yasmina	Faculty of Medicine & Health Sciences, Universitas Lambung Mangkurat	
P121	Blood pressure variability and risk of cardiovascular events in real-world clinical settings	Dr	Cheng-Yen	Lu	Da-Yeh University	
P122	Cognitive Impairment Among Patients with Cardiovascular Diseases: Comparisons of Sex, Elderly, Education	A/Prof	Dujrudee	Chinwong	Chiang Mai University	
P123	Combination therapy with sacubitril/valsartan and SGLT2 inhibitors for HFrEF with renal dysfunction		Tung-Chun	Chien	Graduate Institute of Clinical Pharmacy, National Taiwan University1, Taipei, Taiwan	
P125	Different potency of statin on major adverse cardiovascular events among Taiwanese patients		Yen Hsun	Chen	National Cheng Kung University, Tainan, Taiwan	
P126	Discrepancies between Prescribed and Defined Daily Doses of Four-Pillar Therapy in Congestive Heart Failure Patients	Dr	Nikita	Pal	JSS College of Pharmacy, Mysuru	
P127	Epidemiology of Worsening Chronic Heart Failure: A Population-based Retrospective Cohort Study		Yin	Xuan	China Pharmaceutical University	
P128	Epidemiology, characteristics, and prognosis of heart failure with partial improved ejection fraction		Yin	Xuan	China Pharmaceutical University	
P129	Evaluation of Clinical Characteristics and 90-day Outcomes amongst Heart Failure Patients: Insights from a Tertiary-care Hospital Settings	Dr	Nikita	Pal	JSS College of Pharmacy, Mysuru	
P130	Identification of Drug-related Problems Associated with Stroke Management: A Hospital- based Observational Study		Dr. Aarohi	Vashi	JSS College of Pharmacy, Mysuru	
P131	Knowledge, Attitude & Practice of Patients Toward Cardiovascular Disorders Attending the Out-Patient Department of Cardiology	Dr	Nikita	Pal	JSS College of Pharmacy, Mysuru	
P132	Long-term use of beta-blocker therapy after myocardial infarction		Caroline	Trin	Monash University	
P133	Lower Limb Amputation Association with Sodium-Glucose co-Transporter-2 inhibitors: Systematic review and Meta-Analysis		Solaiman	Alhawas	SFDA	



CARDIOVASCULAR						Venue E2
Poster Board	Paper Title	Title	First Name	Last Name	Organization	
P134	Outcomes of PCSK9 Inhibitors users with ASCVD: a cohort study in China	Dr	Tiantian	Ma	Laboratory of Data Discovery for Health	
P135	Prescription Patterns of Lipid-lowering Therapies in Patients with Atherosclerotic Cardiovascular Disease (ASCVD)	Dr	Nikita	Pal	JSS College of Pharmacy, Mysuru	
P136	Prescription patterns of oral anticoagulants in older adults with atrial fibrillation	Dr	Shota	Hamada	Institute for Health Economics and Policy	
P137	Real-World Characteristics, Treatment Patterns, and Outcomes in Patients with ASCVD in China		Jamei	Liu	China Pharmaceutical University	
P139	Risk of cancer comparing warfarin and direct oral anticoagulants	Dr	Zixuan	Wang	London School of Hygiene and Tropical Medicine	
P140	Risk of Stroke Associated with NSAID among Osteoarthritis Patients with Atrial Fibrillation	Prof	Zhen-Fang	Lin	National Taiwan University	
P141	Sodium-glucose cotransporter 2 inhibitors and cardiovascular events across body mass index		Hwa Yeon	Ko	Sungkyunkwan University	
P142	Statins and intracerebral hemorrhage risk: a target trial emulation study in China	Dr	Yang	Xu	Peking University Health Services Centre	
P143	Systematic review and meta-analysis of DOACs versus LMWH in Cancer-Associated venous Thrombosis		Wei	Kang	The University of Hong Kong	
P144	Trend of treatment patterns and lipid control for primary prevention of ASCVD		Qiuyan	Yu	University of Hong Kong	
P145	Trends in Obstructive Sleep Apnea incidence in Taiwan from 2004 to 2020		Zhen Han	Oh	Shuangho hospital ministry of health and welfare	

COST- EFFECTIVENESS AND ECONOMIC EVALUATIONS						Venue E2
Poster Board	Paper Title	Title	First Name	Last Name	Organization	
P146	Evaluation of clinical and economic implications of adverse drug reactions in a tertiary care teaching hospital.		Sindoora	DS	JSS College of Pharmacy, Mysuru	
P147	Examining Quality of Life in Individuals Experiencing Adverse Drug Reactions: The Application of the WHOQOL-BREF Scale for Evaluation		Marwa	Muhammed	JSS College of Pharmacy	
P148	Cost-effectiveness analysis of the first-line treatment with nivolumab plus ipilimumab in mesothelioma		Zhaoyan	Chen	West China Hospital of Sichuan University	
P149	Economic evaluation of medical expenses in home medical care (Zaitaku) using NDB		Kazuo	Ishii	Suwa University of Science	
P150	Health economic evaluation of self-injection of biologics in patients with rheumatoid arthritis.		Kazuhiko	Takahata	Department of Public Health and Epidemiology, Meiji Pharmaceutical University	
P151	Quality of Life in Post Stroke Patients: Impact of Clinical factors.		Raghava Kalyan	Maddukuri	Chebrolu Hanumaiah Institute of Pharmaceutical Sciences	
P152	Research on the evidence development of benefit-risk in TCM formula granules		Yunfeng	Lai	Guangzhou University of Chinese Medicine	

COVID - 19						Venue E2
Poster Board	Paper Title	Title	First Name	Last Name	Organization	
P153	Association of COVID-19 Policy Stringency on Patient Satisfaction in Chinese Community Pharmacy		Ruijian	Huang	School of International Pharmaceutical Business, China Pharmaceutical University, Nanjing, Jangsu, China	
P154	Effects of COVID-19 on Infectious Events in Patients with CLL in China		Liu	Yin	China Pharmaceutical University	
P155	Health equity of COVID-19 monoclonal antibodies at a US medical center	Dr.	Anna	Kiyomi	Tokyo University of Pharmacy and Life Sciences	
P156	Healthcare utilization and disease status of herpes zoster during COVID-19 pandemic		Jn-Yi	Lin	Department of Pharmacy, Taipei City Hospital Zhongxing Branch, Taiwan	
P157	How the Characteristics and Pattern of SARS CoV-2 Affected Their Virulence	Miss	SM	Rezvi	Universitas Andalas	
P158	Impact of COVID-19 pandemic on adherence to antidepressants in Saudi Arabia	Dr	Khalid	Orayj	King Khalid University	
P159	Molnupiravir for non-hospitalized adults with mild/moderately severe coronavirus disease 2019 (COVID-19)	Dr	George	Okoli	The University of Hong Kong	
P160	Nirmatrelvir-ritonavir regimen for non-hospitalized adults with mild/moderately severe coronavirus disease 2019 (COVID-19)	Dr	George	Okoli	The University of Hong Kong	
P161	Post-COVID19 Perception, Knowledge, and Phobia towards Corticosteroids among the General Public	Dr	Mohammed Salim	KT	Manipal College of Pharmaceutical Sciences, Manipal Academy of Higher Education	
P162	Risk of mortality of COVID-19 & influenza co-infection: A clone-censor-weight study		Jack Chi-him	Lau	The University of Hong Kong	
P163	Risk of narcolepsy after COVID-19 vaccination in Korea: self-controlled case series study	RN	Suvin	Park	Ewha Womans University	
P164	Self-medication among elderly during COVID-19 in Macao: a cross-sectional study		Yu	Zheng	University Of Macau	
P165	The health condition after COVID-19 infection stratified by initial disease-severity		Ran	Zhang	The University of Hong Kong	
P166	The Impact of COVID-19 restrictions on Emergency Bellwether Procedures in Asia	Dr	Sze Ling	Chan	SingHealth	
P167	The Psychological Impact of the COVID-19 Pandemic on the General Population in India: Insights from a Nationwide Survey		Amal	Anand	The Center for Pharmacoepidemiology and Treatment Sciences, Rutgers University	
P168	Vaccination is protective against post-Covid-19 multimorbidity incidence: a territory-wide retrospective cohort study		Boyan	Liu	Department of Pharmacology and Pharmacy, The University of Hong Kong	
P701	Effectiveness of Nirmatrelvir-Ritonavir on Patients with COVID-19: A Nationwide Study in Taiwan	Prof.	Raymond	Kuo	National Taiwan University	

DIABETES AND METABOLIC DISEASES						Venue E2
Poster Board	Paper Title	Title	First Name	Last Name	Organization	
P169	Investigation of Severe Hypoglycemia Risk among Lyumjev® Treated Diabetic Patients in Japan	Dr.	Machiko	Minatoya	Eli Lilly Japan	
P170	Prevalence and predictors of adverse events with DPP-4 inhibitors: A cross-sectional study	Dr	Swetha R	Reghunath	Manipal College of Pharmaceutical Sciences, Manipal Academy of Higher Education	
P171	Adherence to routine medical examinations among patients with type 2 diabetes mellitus		Yu-Tung	Huang	National Taiwan University	

DIABETES AND METABOLIC DISEASES						Venue E2
Poster Board	Paper Title	Title	First Name	Last Name	Organization	
P172	Anemia and SGLT2 Inhibitors in Patients with Diabetes across Different CKD Stages		Ja Chian	Hu	National Cheng Kung University, Taiwan	
P173	Assessment of Treatment Satisfaction, quality of life in Type 2 DM Patients	Dr	Sai Pawan	A R	Vikas College of Pharmaceutical Sciences	
P174	Associated Factors of Cardiovascular Events in Diabetes Outpatients at Teaching Hospitals		Eka Kartika	Untari	Gadjah Mada University	
P175	Association of metabolic comorbidities with chronic hepatitis B progression among Chinese patients		Meng	Shu	Global Epidemiology, Janssen Research & Development, LLC, Shanghai, China.	
P176	Association of multimorbidity intervals with mortality among people with diabetes		Wenlong	Liu	Department of Pharmacology and Pharmacy, The University of Hong Kong	
P177	Benzodiazepines use in patients with obstructive sleep apnea and diabetes mellitus		Liang-Chen	Hsia	Taipei Medical University-Shuang Ho Hospital, Ministry of Health and Welfare	
P178	Bridging the link between diabetes and chronotype: A first study in India		A S	Shriya	JSS College of Pharmacy, Mysuru	
P179	Cardiovascular Outcomes in Patients with Type 2 Diabetes and Obstructive Sleep Apnea	Dr	Ting-Hsuan	Lee	Taipei Medical University - Shuang Ho Hospital, Ministry of Health and Welfare	
P180	Cardiovascular risk of colchicine in patients with type 2 diabetes and gout		Minjeong	Jeon	Sungkyunkwan University	
P181	Comparison of Biguanides and DPP-4 Inhibitors on Cardio-Cerebrovascular Outcomes, Complications, and Costs	Dr	Eiji	Nakatani	Graduate School of Medical Science Nagoya City University	
P182	FINDRISC for detecting metabolic syndrome: Findings from an Indonesian national health survey		M Rifqi	Rokhman	Universitas Gadjah Mada	
P183	Geographic variation in SGLT2i and GLP-1RA use for type 2 diabetes	Dr	Michael	Falster	UNSW	
P184	Risk analysis of ezetimibe and drug-induced liver injury in Taiwan		CHIH-HAN	LIN	Taipei City Hospital Zhongxing Branch	
P185	Safety of SGLT2 inhibitors in type 1 diabetes: real-world experience in Japan	Prof	Masato	Takeuchi	Shizuoka Graduate University of Public Health	
P186	Sodium-glucose cotransporter 2 inhibitors and suicide in patients with diabetes and depression		Daniel Hsiang-Te	Tsai	National Cheng Kung University	
P187	The association of SGLT2i versus DPP4i with incident anemia in Hong Kong.	Dr	Chun Ming Philip	Au	University of Hong Kong	

DRUG SAFETY						Venue Ito B1F Gallery 1
Poster Board	Paper Title	Title	First Name	Last Name	Organization	
P188	Evaluation of the ADR Reporting System at a South Indian Teaching Hospital	Dr	Ramesh	Adepu	Vikas College of Pharmaceutical Sciences	
P189	Adverse reaction signal mining of off-label use of immune checkpoint inhibitors based on the FAERS database		Jaxin	Cai	Nottingham Ningbo China Beacons of Excellence Research and Innovation Institute, University of Nottingham Ningbo China	
P190	Assessment of Drug Information Resources for Recommendations on Renal Drug Dosage Adjustment		Atiqulla	Shariff	JSS College of Pharmacy, Mysuru	
P191	Bruton Tyrosine Kinase Inhibitors and Potential Risk of Drug-Induced Liver Injury		Waad	Altayyar	saudi food and drug authority	
P193	Comparative Review: Overseas Safety Information Utilization in Japan, Australia, and the EU		Yeh Hyun	Kim	Ewha Womans University	
P194	Corticosteroid Adverse Effects: A Comprehensive Study on Occurrence, Severity, and Preventability		Jeesa	George	Faculty of Pharmacy, M. S. Ramaiah University of Applied Sciences	

DRUG SAFETY						Venue Ito B1F Gallery 1
Poster Board	Paper Title	Title	First Name	Last Name	Organization	
P195	Determine the Nature, Pattern, and Rate of Adverse Drug Reactions among Patients of Tertiary Care Hospital		Haris	Aman	JSS College Of Pharmacy, Mysuru	
P196	Evaluation of medication safety program in ambulatory patients with chronic disease	Dr	Ravindra P	Choudhary	JSS College Of Pharmacy, Mysuru	
P197	Exploring Drug Interactions in a Hematopoietic cell transplant unit: A comprehensive analysis		Litty	K	Ms Ramaiah University of applied sciences	
P198	Omeprazole and Potential Risk of Erectile Dysfunction		Solaiman	Alhawas	SFDA	
P199	Polypharmacy was positive associated with inflammatory makers in US older adults		Chun	Chen	Guizhou Provincial People's Hospital, 83 East Zhongshan Road, Guiyang, Guizhou Province, 550002, China.	
P200	Pulmonary Events Associated with Proteasome Inhibitors: Quantitative Signal Detection Using FAERS Database		Muhammed	Favas KT	National Institute of Pharmaceutical Education and Research (NIPER). S.A.S. Nagar	
P201	Risk of Drug-drug Interaction in Gout Arthritis Patients Prescribed NSAIDs	Dr	Mohammad	Bakhriansyah	Faculty of Medicine and Health Sciences, Universitas Lambung Mangkurat	
P202	Risk of Fracture Associated with Pregabalin or Mirogabalin Use: A Case-Case-Time-Control Study		Hinako	Wakabayashi	Graduate School of Medicine and Public Health, Kyoto University	
P203	Study of adverse drug reactions and its clinical and economic implications of ADRs in Intensive Care Units.		Sindoorra	DS	JSS College of Pharmacy, Mysuru	
P204	Trends in Adverse Drug Reactions in Ghana- Evidence of spontaneous reports, 2005-2021		Linda	Nyame	Southeast University	
P205	Variation of Adverse Drug Events in Different Settings in Africa: Systematic Review		Linda	Nyame	Southeast University	

DRUG UTILIZATION AND ADHERENCE						Venue Ito B1F Gallery 1
Poster Board	Paper Title	Title	First Name	Last Name	Organization	
P206	Extra labeled use Among Pet Owners: Insights from Saudi Arabia	Dr.	Jsha	Myalil Lucca	Gulf medical University	
P207	Impact of Clinical Pharmacist Counselling on Medication Adherence among Cognitively Impaired Geriatrics		Varsha	N K	JSS College of Pharmacy, Mysuru	
P208	Prescription status of centrally acting muscle relaxants in Korean elderly		Dayeon	Kim	Korea Institute of Drug Safety & Risk Management	
P209	Prevalence and Patterns of Drug-Related Problems Among Elderly Patients in Critical-Care Units		Sruthy	Jose	JSS College Of Pharmacy Mysore	
P210	Usage trends of government-subsidised cancer drugs in Australia: an analysis		Jasmine	Lee	The University of Sydney	

GERIATRIC AND FRAILTY RELATED STUDIES						Venue Ito B1F Gallery 1
Poster Board	Paper Title	Title	First Name	Last Name	Organization	
P211	Development of Claim-Based Frailty Index in A Nationwide Database		Shu Ping	Huang	Changhua Christian Hospital	
P212	End-of-life medication management: A Delphi consensus approach in the Western Pacific region		Xin Er	Yaw	Monash University Malaysia	
P213	Potential drug-drug interactions in geriatric outpatients with depression in China		Hui	Zhou	The First Affiliated Hospital of Xi'an Jiaotong University	

GERIATRIC AND FRAILITY RELATED STUDIES					Venue Ito B1F Gallery 1
Poster Board	Paper Title	Title	First Name	Last Name	Organization
P214	Prevalence and risk factors of potentially inappropriate medication use in older Australians.		Edward Chun Yin	Lau	The University of Sydney
P215	Statin Therapy for Primary Prevention in Old and Very Old Adults		Wanchun	Xu	The University of Hong Kong

HEALTH POLICY					Venue Ito B1F Gallery 2
Poster Board	Paper Title	Title	First Name	Last Name	Organization
P216	Geographic Variations in Nicotine Dependency Treatment Use in Japan		Keiko	Asao	Kappa Medical K.K.
P217	"Biopsychosocial Determinants of CLBP in Northern India: A Population-Based Cross-Sectional Analysis"		Saroj Kundan	Bharti	NIPER Mohali
P218	Assessment of new anti-cancer biological products approved through Priority Review in China	Prof	Liu	Pengcheng	China Pharmaceutical University
P219	Community Pharmacists' Health Screening Services: Knowledge, Attitudes, Practice and Barriers	Dr	Sreedharan	Nair	Dept. of Pharmacy Practice, Manipal College of Pharmaceutical Sciences, Manipal Academy of Higher Education
P220	Comparison of Health Literacy Between Immigrants and Natives in Taiwan		Pei-Yen	Yeh	National Taiwan University
P221	Enhancing Health Equity: Evaluating South Africa's CCMD Program		Maggie	Munsamy	National Department of Health, South Africa
P222	Exploring Healthcare Professionals' Attitude and Perceptions Towards Digital Health Technologies: A Cross-sectional Study	Dr	Gangadharappa	HV	JSS College of Pharmacy, JSS Academy of Higher Education and Research
P223	Exploring Pharmacoepidemiology for Advancing Rare Diseases and Orphan Drug Research: Indian Perspective		Sangita	Mishra	JSS College of Pharmacy, Mysuru
P224	Five-year comparison of biological product approvals in Indonesia and the United States	Prof	Erna	Kristin	Faculty of Medicine Public Health and Nursing, Universitas Gadjah Mada
P225	Impact of ambulatory pharmacist-led telephonic intervention on patient's health-related quality of life	Dr	Ravindra P	Choudhary	JSS College of Pharmacy, Mysuru
P226	Impact of onco-clinical pharmacist in hematological centre: A re-aim framework analysis	Miss	Litty	K	Ms Ramaiah University of applied sciences
P227	Implementation and assessment of the developed MEDSTIK Tool in community pharmacies		Meenakshitha	Panyala	JSS College of Pharmacy, Mysuru
P228	Implementation of deprescribing in psychiatry: A prospective interventional study	Dr	Srikanth	Malavali Siddalingegowda	JSS College of Pharmacy, Mysuru
P229	Improving Comprehension of Oncology Drug Related Issue after Pharmacist Education		Pei Yuan	Hung	Taichung Tzu Chi Hospital, Buddhist Tzu Chi Medical Foundation
P230	Promoting Materiovigilance: Empowering Community Pharmacists with Sensitization Initiatives	Dr	Adusumilli	Pramod Kumar	Ramaiah University of Applied Sciences
P231	Real world evidence in regulatory decision making: Current status & future prospects	Dr	Venkatesh	MP	JSS College of Pharmacy, Mysuru
P232	Setting research-priorities for safe and rational use of medicines in Indian context	Dr	Sowparnika	Treasa Sabu	Indian Council of Medical Research (ICMR) Headquarters

HEALTH POLICY					Venue Ito B1F Gallery 2
Poster Board	Paper Title	Title	First Name	Last Name	Organization
P233	Social media detoxification in pharmacy students: RCT study		Panida	Horsiriluck	Faculty of Pharmacy, Chiang Mai University
P234	Standardized Approach to Obtain Patients feedback on RMMs Shape and Content		Naser	Aljaser	Saudi Food and Drug Authority
P235	The context and perspectives for implementing a tailored pharmacist-led intervention in Indonesia		Indriastuti	Cahyaningsih	Universitas Muhammadiyah Yogyakarta
P236	The Impact of Volume-based Procurement on the Spatial Accessibility of Insulin		Lu	Lu	China Pharmaceutical University

METHODS					Venue Ito B2F
Poster Board	Paper Title	Title	First Name	Last Name	Organization
P237	A Comparative Review of International Common Data Models for Vaccine Safety		Yulin	Wang	Peking University
P238	A scoping review for Emulating a Target Trial in Vaccine	Prof	Naohiro	Yonemoto	University of Toyama
P239	Distributed learning in effect estimation using routinely collected healthcare data: a systematic review		Junting	Yang	Peking university
P240	Evaluation of time-related bias with non-user control		Hiroya	Morita	Tokyo Medical University
P241	Lasso-type shrinkage method for the modified Poisson and least-squares regressions		Takahiro	Kitano	The Graduate Institute for Advanced Studies, The Graduate University for Advanced Studies
P242	Methods applied to assess real-world effectiveness of drugs: A scoping review		Benedikte Irene	von Osmanski	Signum Life Science
P243	Outlier detection and influence diagnostics for dose-response meta-analysis		Kohei	Yamaguchi	Department of Statistical Science, School of Multidisciplinary Sciences, The Graduate University for Advanced Studies
P244	Exploring Methodologies to Incorporate Patient Voice in Pharmacoepidemiology Studies		Yvonne	Lee	IQVIA Solutions Asia

NEUROLOGY					Venue Ito B2F
Poster Board	Paper Title	Title	First Name	Last Name	Organization
P245	Characteristics of Duchenne Muscular Dystrophy Patients in Taiwan: A Population-Based Study		Hung-Wei	Lin	IQVIA Solutions Taiwan
P246	Epidemiological studies on the genetic background in the development of subacute myelo-optico-neuropathy		Hideki	Matsumoto	Graduate School of Medicine, Gifu University
P247	Riluzole use for motor neuron disease and all-cause mortality: A time-to-event analysis		Min	Fan	University of Hong Kong
P248	Treatment patterns among patients with myasthenia gravis: An insurance claims database study		Izumi	Mishiro	UCB Japan Co., Ltd.
P249	Valbenazine in Tardive Dyskinesia: Meta-analysis of RCTs and Retrospective Study of FAERS.		Beema	TYoosuf	National Institute of Pharmaceutical Education and Research (NIPER)

# Poster Program

Monday, 14 October 2024

INFECTIOUS DISEASE						Venue E2
Poster Board	Paper Title	Title	First Name	Last Name	Organization	
P300	A study to assess drug related problems associated with anti-tubercular medications.		Shilpa	Palaksha	JSS College of Pharmacy, JSS AHER, Mysuru	
P301	Adverse drug reaction in drug-resistant tuberculosis patients: a retrospective study		Githa Fungie	Galistiani	Universitas Muhammadiyah Purwokerto	
P302	Antimicrobial treatment for inpatient bacterial bloodstream infection in Hong Kong (2012-2021)		Guanhao	Zheng	The University of Hong Kong	
P303	Assessing Metronidazole and Tinidazole for Anaerobic Infections: A Case-Control Study		Vaishnavi	Pawar	JSS College of Pharmacy, Mysuru Karnataka	
P304	Assessment of antimicrobial dosing appropriateness in chronic kidney disease patients		Gayatri R	Panicker	Manipal College of Pharmaceutical Sciences, Manipal, Karnataka, India	
P305	Changing trends in influenza mortality among regions from 2001 to 2022		Nanami	Sako	Department of Pharmaceutical Data Science, Faculty of Pharmacy, Okayama University, Okayama, Japan	
P306	Clinical and economic evaluation of Xuebijing injection for sepsis treatment in China	Dr	Yunfeng	Lai	Guangzhou University of Chinese Medicine	
P307	Comparative Effect of Four Antimalarial Treatments on Haematocrit in Children Southwest, Nigeria	Dr	Zacchaeus	Olofin	University of Ibadan	
P308	Comparing Effectiveness and Safety of Conventional versus Super-Bioavailable Itraconazole in Dermatophytosis	Dr	Apeksha	Merja	Enliven Skin Care	
P309	Consumption and expenditure on fidaxomicin and oral vancomycin for Clostridioides difficile infection in 43 countries and regions		Yin	Zhang	The University of Hong Kong	
P310	Drug interactions in people living with HIV with comorbidities versus without comorbidities		Rajesh	Radhakrishnan	Manipal College of Pharmaceutical sciences, Manipal Academy of Higher Education, Manipal	
P312	Epidemiology of serious side effects from macrolide and risk management in Thailand		Pakawadee	Sriphiromya	Ministry of Public Health	
P313	Evaluation of role-play to improve community health workers knowledge on antimicrobial resistance.	Dr	Rosy	Raju	JSS College of Pharmacy	
P314	Global influenza mortality trends: a joinpoint regression analysis		Maki	Yamamoto	Department of Pharmaceutical Data Science, Faculty of Pharmacy, Okayama University	
P315	Impact of direct-acting antiviral treatment on total cholesterol metabolism in hepatitis C		Hsuan-Yu	Hung	School of Pharmacy, College of Pharmacy, Kaohsiung Medical University, Kaohsiung, Taiwan	
P316	Knowledge, attitude and practice towards tuberculosis among students at a Saudi Arabia	Dr	Dalia	Almaghaslah	King Khalid University	
P317	Liver Enzymes During and After Artemether-Lumefantrine Therapy with Uncomplicated Plasmodium Falciparum Infection	Dr	Zacchaeus	Olofin	University of Ibadan	

INFECTIOUS DISEASE						Venue E2
Poster Board	Paper Title	Title	First Name	Last Name	Organization	
P318	Patterns of Antibiotic-Resistance and Multi-Drug Resistance in Clinical-Specimens: A Four-Year Retrospective Analysis	Dr	Theempalangad	Rovin M	Centre for Clinical Research Excellence	
P319	Perception of antibiotic deprescribing among physicians in a tertiary healthcare facility	Dr	Sonal Sekhar	Miraj	Manipal College of Pharmaceutical Sciences	
P320	Perspectives of community pharmacy staff towards antimicrobial resistance: Findings from qualitative study	Dr	Rosy	Raju	JSS College of Pharmacy	
P321	Post-marketing study to assess serotype-specific effectiveness of Rotavirus Vaccine (ROTATEQ®) in China	Dr	Jahuang	Lin	MSD R&D China	
P322	Quality appraisal of antibiotic use through defined daily dose in a south Indian hospital- A point prevalence study		Linu Mohan	P	Al Shifa College of Pharmacy	
P324	Reviewing and Improving Legislations to Tackle Antimicrobial Resistance		Sarah	Altamimi	Saudi Food and Drug Authority	
P325	The Profile of Glucocorticoid-Induced Leucine Zipper Protein in Sepsis Patients with Comorbidity		Mutia	Lailani	Universitas Andalas	
P326	Trends in Seasonal Influenza Mortality From 2001 to 2022 in Fourteen Countries		Mariko	Fujii	Okayama University	

KIDNEY						Venue E2
Poster Board	Paper Title	Title	First Name	Last Name	Organization	
P327	Comparison of serum procalcitonin and C-reactive protein levels for diagnosis of AKI	Dr	Vijayanarayana	Kunhikatta	Manipal College of Pharmaceutical Sciences	
P328	Economic Burden of Anemic Chronic Kidney Disease in China		Yuqing Y	Bao	China Pharmaceutical University	
P329	Longitudinal hemoglobin trajectories-associated major kidney outcomes in non-dialysis-dependent and dialysis-dependent CKD patients		Zi-Yang	Peng	Institute of Clinical Pharmacy and Pharmaceutical Science, College of Medicine, National Cheng Kung University, Tainan	
P330	Patient Journey of Diabetic Kidney Disease using an EMR database in Japan		Mio	Kubo	EPS Corporation, Real World Evidence Headquarters	
P331	Prevalence and Treatment Patterns of Nocturnal Polyuria in Taiwan: Findings from the National Health Insurance Research Database		Yu-Tzu	Tseng	Department of Pharmacy, National Taiwan University	
P332	Real-world evaluation of sevelamer in chronic kidney disease: a retrospective cohort study		Winnie	Foo	Agency for Care Effectiveness, Ministry of Health	
P333	Travel and accessibility challenges in dialysis patients: A survey	Dr	Prasanna	Kumar	Manipal College of Pharmaceutical Sciences, Manipal Academy of Higher Education	



MALIGNANCY						Venue E2
Poster Board	Paper Title	Title	First Name	Last Name	Organization	
P334	(CAR) T cell Immunotherapies and Potential association of Secondary T-Cell Malignancies		Maha	Alghamdi	Saudi food and drug Authority	
P335	Adverse events after receiving denosumab among solid tumor cancer patients in Taiwan		Wei-Ju	Chen	Amgen Taiwan Limited.	
P336	Cancer Drug Use of Childhood Cancer Patients in China: A Cross-sectional Analysis		Yichen	Zhang	Peking University	
P337	Cardiac Injury in Non-Small Cell Lung Cancer Patients on Immune Checkpoint Inhibitors		Xuan	Yin	China Pharmaceutical University	
P338	Characteristics of Diffuse Large B-cell Lymphoma Patients receiving R-CHOP Therapy with/without G-CSF		Osamu	Nagao	RAD-AR Council	
P339	Characteristics, treatment, clinical outcomes in Chinese CLL following discontinuation of BTKi therapy	Dr	Jahuang	Lin	MSD R&D China	
P340	Comparative Evaluation of PEG-rhG-CSF vs rhG-CSF for Febrile Neutropenia in Lymphoma		Qu	Ying	The Third Affiliated Hospital of Soochow University	
P341	Comparison of adverse drug reactions in bone marrow transplant and hemat-onco setting		Litty	K	Ms Ramaiah University of Applied Sciences	
P342	Differences for CLL Patients Between China and US: A Large-Scale Comparative Study		Lin	Yin	China Pharmaceutical University	
P343	Disproportionality analysis on immune checkpoint inhibitors using a spontaneous adverse event reporting		Ju Won	Lee	College of Pharmacy and Department of Global Innovative Drugs, Chung-Ang University, Seoul, Korea	
P344	Early-Onset Gastric and Colorectal Cancer in Japan and the US	Dr	Elsie	Horne	Flatiron Health	
P345	Exploration of theragnostic target along the central dogma of anaplastic thyroid cancer		Ushnaa	Kuri	Ramaiah University of Applied Sciences	
P346	Investigating the preventive colorectal cancer screening among US adults by diabetes status		Yu-Tzu	Chen	Taipei Medical University	
P347	P+C+OMCT vs. TPF regimen as neoadjuvant chemotherapy in head & neck cancer		Shruti	Soni	L. M. College of Pharmacy	
P348	Predict prostate cancer mortality: an application of real-world data-driven, time-inhomogeneous Markov model		Jaqi	Wang	The University of Hong Kong	
P349	Prevalence and trajectories of multiple medicine use in people with colorectal cancer	Dr	Benjamin	Daniels	UNSW Sydney	
P350	Real-world Treatment Patterns of Trastuzumab Deruxtecan (T-DXd) in Chinese Breast Cancer Patients		Fan	Yang	China Pharmaceutical University	
P351	Recent Review of Population-based Cancer Registries in the US, Europe, and Korea		Minji	Kim	Ewha W. University	
P352	Relationship between Dose Intensity and Effectiveness of Cyclin-Dependent Kinase 4/6 Inhibitors		Ming-Yi	Huang	Linkou Chang Gung Memorial Hospital	
P353	Safety evaluation of rituximab biosimilar products using real-world data in Japan		Kimie	Sai	National Institute of Health Sciences	

MALIGNANCY						Venue E2
Poster Board	Paper Title	Title	First Name	Last Name	Organization	
P354	Systemic exposure of VEGF/VEGFR inhibitors: artery dissection risk assessment using claims data	Dr	Takashi	Waki	Pharmaceuticals and Medical Devices Agency	
P355	Tamoxifen and risk of uterine diseases in young women with breast cancer		Pei-Chun	Chen	National Health Research Institutes	
P356	Design and synthesize the potent and less toxic HoLu-7 as anticancer agent		Hui-Hsia	Hsieh	Taichung Tzu Chi Hospital, Buddhist Tzu Chi Medical Foundation	
P357	Evaluation of Drug Utilization of Trastuzumab Deruxtecan in a Regional Hospital		Tzu Cheng	Wang	Taichung Tzu Chi Hospital, Buddhist Tzu Chi Medical Foundation	

MEDICAL EDUCATION						Venue E2
Poster Board	Paper Title	Title	First Name	Last Name	Organization	
P358	A systematic review of healthcare professionals' capacity building in regenerative medicine		Junnan	Shi	University of Macau	
P359	Assessment of Knowledge, Attitude, Practice Towards Appropriate Medication Use in High School	Dr	Manjula	Santhepete	JSS College of Pharmacy, Mysuru	

OPIOIDS AND PAIN MEDICATION						Venue E2
Poster Board	Paper Title	Title	First Name	Last Name	Organization	
P360	A scoping review on the research landscape of Fentanyl in pediatric oncology.	Dr	Shwetha	Somakumar	Department of Pharmacy Practice, Manipal College of Pharmaceutical Sciences, Manipal, Karnataka	
P361	Comparative Study of Morphine versus Tapentadol in Cancer Pain Management	Dr	Rajesh	V	Manipal College of Pharmaceutical Sciences, Manipal Academy of Higher Education	
P362	The rate of naloxone use in emergency departments in the United States		Minji	Sohn	Ferris State University	
P363	Utilization patterns of analgesics in Indian cancer patients: systematic review and meta-analysis"		Bulusu	Vani Mahathi	All India Institute of Medical Sciences	

OSTEOPOROSIS						Venue E2
Poster Board	Paper Title	Title	First Name	Last Name	Organization	
P364	Adverse drug reactions of Vitamin D: trends in Jangsu and signal detection		Hui	Xue	Southeast University	
P365	Bisphosphonates' Impact on Pain and Quality of Life in Osteoporosis Patients	Dr	Pandji Winata	Nurikhwan	Universitas Lambung Mangkurat	
P366	Utilization of romosozumab in osteoporosis patients: A real-world evidence from Taiwan		Chia-chen	Wu	LinKou Chang Gung Memorial Hospital	

OTHERS						Venue E2
Poster Board	Paper Title	Title	First Name	Last Name	Organization	
P367	Renal Outcomes and Mortality in DME: Aflibercept vs. Ranibizumab	Dr	Wan-Ju Annabelle	Lee	Chi Mei Medical Center	
P368	CFTR modulators for patients with cystic fibrosis: A Bayesian Network Meta-analysis		Mohammed	Safeer V S	National Institute of Pharmaceutical Education and Research (NIPER) S.A.S Nagar	
P369	Comparative Assessment of Pharmacoepidemiological studies of Rare Diseases in Japan and India		Sangita	Mishra	JSS College of Pharmacy, Mysuru	
P370	Efficacy and safety of stem-cell therapy in patients with muscular dystrophy	Dr	Nagita	Devi	Chandigarh Group of Pharmacy, Landran, Punjab, India	
P371	Evaluation of treatment efficacy, risk factors in paraquat poisoning: a decade-long study	Dr	Harsimran	Kaur	Department of Pharmacy Practice, Manipal College of Pharmaceutical Sciences, Manipal Academy of Higher Education	
P372	Impostor syndrome prevalence and factors among northern Thai university students		Siraprapa	Kaewmart	Faculty of Pharmacy, Chiang Mai University	
P373	Indian traditional preparation of Liquorice in the post-operative pain management of haemorrhoids	Prof	Mruthunjaya	Kenganora	JSS College of Pharmacy, Mysuru	
P374	Isolation and quantification of miRNAs from the human saliva	Dr	Manthan	Merja	Enliven Cancer Care	
P375	Post-marketing safety of ustekinumab for psoriasis based on 14-year follow-up in Danish national patient data		Sejun	Kim	Department of Pediatrics and Adolescent Medicine, Danish National University Hospital "Rigshospitalet"	

PEDIATRICS						Venue E2
Poster Board	Paper Title	Title	First Name	Last Name	Organization	
P376	Assessing the association between the combination use of diuretics and the risk of PDA-ligation among PDA infants		Yung-Hsin	Huang	National Cheng Kung University Hospital	
P377	Prolonged off-label antipsychotic therapy and cardiometabolic outcomes in children: a systematic review		Ramya Padmavathy	Radha Krishnan	University of Sydney	
P378	Evaluating the Prognostic Value of the Status Epilepticus Severity Score in Children		Xinchi	Li	China Pharmaceutical University	

POLYPHARMACY						Venue E2
Poster Board	Paper Title	Title	First Name	Last Name	Organization	
P379	A Pharmacist-Led Study on Utilization Patterns of Paliperidone in Polypharmacy Patients		Manohar	SK	JSS College of Pharmacy	
P380	An Ecological study on Polypharmacy and Dementia using NDB open data Japan		Naoko	Ushida	Teikyo University Graduate School of Public Health	
P381	Associations of polypharmacy with oral microbiome in US middle-aged and older adults	Dr	Kai	Wei	Guizhou Provincial People's Hospital	
P382	Cardiovascular related polypharmacy and its association with liver and kidney function		Caroline	Trin	Monash University	

PREGNANCY AND MATERNAL HEALTH						Venue E2
Poster Board	Paper Title	Title	First Name	Last Name	Organization	
P383	Access to Contraceptives and Abortion Medications in High Income and LMICs	Dr	Dima M	Qato	University of Southern California	
P384	Evaluation of the Pregnancy Safety Information of Antineoplastic: The SFDA Experience		Manal	Alrohaimi	Saudi Food and Drug Authority	
P385	Impact of severe maternal morbidity on perinatal outcomes in the United States		Qi	Lu	Shanghai Children's Medical Center, School of Medicine, Shanghai Jiao Tong University	
P386	Infertility-Associated Psychological Stress: Optimizing FertiQoL Threshold Using Machine Learning Versus Biostatistical Models		Yu-Hsuan	Lee	National Cheng Kung University	
P387	Inhaled corticosteroids and long-acting beta2-agonists use during pregnancy and adverse fetal outcomes		Yea-Chwen	Wu	National Taiwan University Hospital	
P388	Maternal and Neonatal Adverse Events of Oral Anti-hypertensives in Pregnancy: Disproportionality Analysis		Christy	Thomas	National Institute of Pharmaceutical Education and Research (NIPER), Guwahati, Assam, India	
P389	Oral anti-hypertensives in the treatment of preeclampsia: A systematic review and meta-analysis		Chippy	Anna Jby	National Institute of Pharmaceutical Education and Research (NIPER), Guwahati, Assam, India	
P390	Rheumatoid arthritis medications through before pregnancy and after delivery: JMDC Claims database		Yuichi	Shiotsuki	Keio university	
P391	Safety of omalizumab use during pregnancy on neonatal outcomes	Prof	Chung-Hsuen	Wu	Taipei Medical University	
P392	Systematic review of Chinese epidemiology and risk factors of adverse pregnancy outcomes		Yang	Feng	Xiamen Chazen Biomedical technology Co., Ltd.	

PSYCHIATRY AND COGNITIVE CONDITION						Venue Ito B1F Gallery 1
Poster Board	Paper Title	Title	First Name	Last Name	Organization	
P393	Psychotropic medicine consumption in 83 countries and regions between 2017 and 2022		Caige	Huang	University of Hong Kong	
P394	ADHD Medication Use During Pregnancy and Outcomes in Pregnant Individuals and Newborns		Eunsun	Lim	Ewha Womans University	
P395	Antidepressant Use for Patients with Depression and the Risk of Diabetes		Io	Hasebe	Kyoto University Hospital	
P396	Aripiprazole versus Second-generation Antipsychotic Use in Schizophrenia and Risk of Cardiovascular Events		Kuan-Ting	Chou	Taipei Medical University	
P397	Assessing drug utilization in cognitive impairment among the elderly population- A hospital-based longitudinal study		Jgnasa	Chiramana	JSS College of Pharmacy, Mysuru	
P398	Assessment of DRP associated with use of psychiatric medication among non-psychiatric patients		Srikanth	M S	Faculty, JSS College of Pharmacy, Mysuru, INDIA	
P399	Assessment of Caregiver Burden among Caregivers of the Cognitively Impaired Patients		Veerendra	A G	JSS academy of higher education and research (JSS college of pharmacy, Mysuru)	
P400	Association between lithium use and stroke risk: nationwide self-controlled case series study		Chen-Yi	Yang	National Cheng Kung University	
P401	Association between Social Media Addiction and Impostor Syndrome among Undergraduate Students.		Wannisa	Seangsanoah	Faculty of Pharmacy, Chiang Mai university	

PSYCHIATRY AND COGNITIVE CONDITION					Venue Ito B1F Gallery 1
Poster Board	Paper Title	Title	First Name	Last Name	Organization
P402	Association between the Use of Incretin-Based Therapies and the Risk of Depression		Shih-Yu	Liu	Graduate Institute of Clinical Pharmacy, College of Medicine, National Taiwan University, Taipei, Taiwan
P403	Association of road traffic injuries with gabapentinoid treatment: a self-controlled case-series study		Siu Chung Andrew	Yuen	UCL School of Pharmacy
P404	Barriers and Influential Factors in Quitting/Reducing E-Cigarette Use Among University Students	A/Prof	Surarong	Chinwong	Faculty of Pharmacy, Chiang Mai University
P405	Burden of depressive disorders in Vietnam from 1990 to 2019		Quynthi	Vu	Graduate School of Medicine, Dentistry and Pharmaceutical Sciences, Okayama University
P406	Clinical Spectrum and Management Challenges of Reflex Epilepsy: Insights from Northeast India		Ruby	Kasana	National Institute of pharmaceutical education and research (NIPER) Guwahati
P407	Effect of drug utilization review on prescription of typical antipsychotics to elderly		Suji	OH	Korea Institute of Drug Safety & Risk Management
P408	Evaluating LID Prevalence and Influencing Factors in PD Patients: A Pharmacovigilance Study		Akanksha	Lahiri	JSS College of Pharmacy, JSSAHER, Mysuru
P409	Evaluations of Mental Health Conditions among Children with and without Diabetes.		Ching-Yi	Su	TMU
P410	Haematological malignancy following clozapine or olanzapine use in schizophrenia: retrospective cohort study		Yuqi	Hu	the University of Hong Kong
P411	HbA1c Recording in Patients with Schizophrenia or Bipolar Disorder in DATuM IDEA®		Nobuo	Mochizuki	TOPPAN Holdings Inc.
P412	Medication Use Evaluation of ADHD Treatment at a Medical Center	Dr	Lu-Hsuan	Wu	National Cheng Kung University Hospital
P413	Persistence and Adherence of ADHD Medications in Japanese patients		Atsushi	Urano	Keio university
P414	Pharmacists' Knowledge, Attitudes, Perceived barriers on providing medication counseling to psychiatric patients		Ishara	De Silva	General Sir John Kotelawala Defence University
P415	Real-world Persistence and Adherence of Paliperidone in Adolescent Schizophrenia Patients in China		Sijia	Dong	Johnson & Johnson
P416	Risks assessment of antiseizure medications related Parkinson's disease between valproate and levetiracetam in adults with seizure		Yurou	Jang	Graduate Institute of Clinical Pharmacy, National Taiwan University
P417	Social media addiction and behavior of social media usage in undergraduate students		Chanapa	Yangmang	Faculty of Pharmacy, Chiang Mai University
P418	The Impact of Winter on the Use of Antidepressants		Lu	Lu	China Pharmaceutical University
P419	The Interconnection Between Depression and Chronic Kidney Disease.		Kan-Chih	Chen	TMU
P420	The role of antipsychotics on associations between extreme temperature and heat-related outcomes	Dr	Zixuan	Wang	London School of Hygiene and Tropical Medicine

PSYCHIATRY AND COGNITIVE CONDITION					Venue Ito B1F Gallery 1
Poster Board	Paper Title	Title	First Name	Last Name	Organization
P421	Trajectories of risperidone use for changed behaviours in people with Alzheimer's disease: a nationwide study		Danika	Davis	Centre of Medicines Use and Safety, Monash University
P422	Umbrella Review on First-Line Therapy Options for Infantile Epileptic Spasms Syndrome		Saroj Kundan	Bharti	NIPER Mohali
P423	ADHD medication use and cardiometabolic conditions in pregnancy: A population-based cohort study	Dr	Masako	Araki	UNSW Sydney

RWD					Venue Ito B1F Gallery 2
Poster Board	Paper Title	Title	First Name	Last Name	Organization
P424	Assessment of Real-World Data Sources and A Hybrid Approach in Evidence Generation		Yvonne	Lee	IQVIA Solutions Asia
P425	Bias description among pharmacoepidemiologic studies applying common data model: a systematic review		Yongqi	Zheng	Peking University
P426	Examination of methods for utilizing unstructured data using "Millennial Medical Record"		Mako	Furukawa	Shionogi & Co., Ltd
P427	The use of real-world evidence in Japan cost effectiveness analyses		Zhihong	Cai	Eli Lilly Japan

SURGERY AND MEDICAL DEVICES					Venue Ito B1F Gallery 2
Poster Board	Paper Title	Title	First Name	Last Name	Organization
P428	Elevated Respiratory Complications following Robotic-Assisted Lobectomy: A National Cohort Analysis		Ruijian	Huang	School of International Pharmaceutical Business, China Pharmaceutical University, Nanjing, Jiangsu, China.
P429	Evaluating In-Hospital Outcomes of the Ross Procedure Using Real-World Data	Dr	Jfang	Zhou	China Pharmaceutical University
P430	Intraoperative Hemodynamics and Postoperative Outcomes in Type A Aortic Dissection		Jfang	Zhou	China Pharmaceutical University
P431	Active surveillance of medical device associated adverse events at tertiary care hospital	Dr	Gangadharappa	HV	JSS College of Pharmacy, JSS Academy of Higher Education and Research
P433	Biological Age's Association with Postoperative Renal Outcomes After Surgery		Xinchi	Li	China Pharmaceutical University
P434	Investigating drug related problems in patients following cardiac surgery: A prospective study		Esha	Mohamed Nisarahmed	MS Ramaiah University of Applied Sciences
P435	Predictive Modeling of Intraoperative Acquired Pressure Injuries		Jfang	Zhou	China Pharmaceutical University
P436	Predictors of post-operative complications in patients following cardiac surgery: A prospective study		Esha	Mohamed Nisarahmed	MS Ramaiah University of Applied Sciences
P437	Sex-specific Roles of Early-postoperative Hemoglobin on Adverse Kidney Outcomes After Cardiac Surgery		Siyu	Kong	China Pharmaceutical University
P438	The Influence of Timing in Cholecystectomy on the Incidence of Post-ERCP Pancreatitis	Dr	Rathod	Mahesh	National institute of pharmaceutical education and research, Guwahati, Assam

VACCINATION					Venue Ito B2F
Poster Board	Paper Title	Title	First Name	Last Name	Organization
P443	Design and Analytical Methods for Vaccine Safety Evaluation		Yukari	Uemura	NCGM
P444	Exploring determinants of human papillomavirus vaccination initiation and completion among adult females	Dr	George	Okoli	The University of Hong Kong
P445	Hepatitis B vaccine safety: Analysis of adverse reactions based on VAERS database		Pengcheng	Liu	China Pharmaceutical University
P446	Impact of the universal seasonal influenza vaccination policy in Manitoba, Canada	Dr	George	Okoli	The University of Hong Kong
P447	Individual characteristics associated with adherence to seasonal influenza vaccination in Manitoba, Canada	Dr	George	Okoli	The University of Hong Kong
P448	Effectiveness of inactivated influenza vaccine against laboratory-confirmed influenza among Chinese elderly	Dr	Jfang	Zhou	China Pharmaceutical University
P449	Repeated vaccination and protective effect of influenza vaccine in the elderly	Dr	Jfang	Zhou	China Pharmaceutical University
P450	Validation of COPD Severity According to the GOLD Framework in Claims Database		Ju-Ling	Chen	Department of Pharmacy, National Cheng Kung University Hospital, Tainan
P451	Validation of ICD-CM codes to identify relapsed metastatic breast cancer in Taiwan		Yan-Lin	Wang	Department of Pharmacy, Linkou Chang Gung Memorial Hospital

# Poster Layout

Posters will be displayed in two venues, Faculty of Engineering Bldg. 2 (Venue E2) and Ito International Research Centre (Venue Ito).

Category	Poster ID	Date	Bldg.	Floor	Location
ADHERENCE	P100 - P107	Sunday, 13 October 2024	E2	2F	Forum
AI AND MACHINE LEARNING	P108 - P111	Sunday, 13 October 2024	E2	2F	Forum
ASTHMA AND COPD	P112 - P114	Sunday, 13 October 2024	E2	2F	Forum
AUTOIMMUNE	P115 - P118	Sunday, 13 October 2024	E2	2F	Forum
CARDIOVASCULAR	P119 - P145	Sunday, 13 October 2024	E2	2F	Forum
COST- EFFECTIVENESS AND ECONOMIC EVALUATIONS	P146 - P152	Sunday, 13 October 2024	E2	2F	Forum
COVID - 19	P153 - P168 & P701	Sunday, 13 October 2024	E2	2F	Forum
DIABETES AND METABOLIC DISEASES	P169 - P187	Sunday, 13 October 2024	E2	2F	Forum
DRUG SAFETY	P188 - P205	Sunday, 13 October 2024	Ito	B1F	Gallery 1
DRUG UTILIZATION AND ADHERENCE	P206 - P210	Sunday, 13 October 2024	Ito	B1F	Gallery 1
GERIATRIC AND FRAILTY RELATED STUDIES	P211 - P215	Sunday, 13 October 2024	Ito	B1F	Gallery 1
HEALTH POLICY	P216 - P236	Sunday, 13 October 2024	Ito	B1F	Gallery 2
METHODS	P237 - P244	Sunday, 13 October 2024	Ito	B2F	Multipurpose Space
NEUROLOGY	P245 - P249	Sunday, 13 October 2024	Ito	B2F	Multipurpose Space
<b>Spotlight1-1</b>	SP500 - SP507	Sunday, 13 October 2024	Ito	B1F	Gallery 1
<b>Spotlight1-2</b>	SP508 - SP514	Sunday, 13 October 2024	Ito	B2F	Multipurpose Space
INFECTIOUS DISEASE	P300 - P326	Monday, 14 October 2024	E2	2F	Forum
KIDNEY	P327 - P333	Monday, 14 October 2024	E2	2F	Forum
MALIGNANCY	P334 - P357	Monday, 14 October 2024	E2	2F	Forum
MEDICAL EDUCATION	P358 - P359	Monday, 14 October 2024	E2	2F	Forum
OPIOIDS AND PAIN MEDICATION	P360 - P363	Monday, 14 October 2024	E2	2F	Forum
OSTEOPOROSIS	P364 - P366	Monday, 14 October 2024	E2	2F	Forum
OTHERS	P367 - P375	Monday, 14 October 2024	E2	2F	Forum
PEDIATRICS	P376 - P378	Monday, 14 October 2024	E2	2F	Forum
POLYPHARMACY	P379 - P382	Monday, 14 October 2024	E2	2F	Forum
PREGNANCY AND MATERNAL HEALTH	P383 - P392	Monday, 14 October 2024	E2	2F	Forum
PSYCHIATRY AND COGNITIVE CONDITION	P393 - P423	Monday, 14 October 2024	Ito	B1F	Gallery 1
RWD	P424 - P427	Monday, 14 October 2024	Ito	B1F	Gallery 2
SURGERY AND MEDICAL DEVICES	P428 - P438	Monday, 14 October 2024	Ito	B1F	Gallery 2
VACCINATION	P443 - P451	Monday, 14 October 2024	Ito	B2F	Multipurpose Space
<b>Spotlight2-1</b>	SP515 - SP521	Monday, 14 October 2024	Ito	B1F	Gallery 1
<b>Spotlight2-2</b>	SP522 - SP529	Monday, 14 October 2024	Ito	B2F	Multipurpose Space



# Engineering Bldg. 2 (Venue E2)

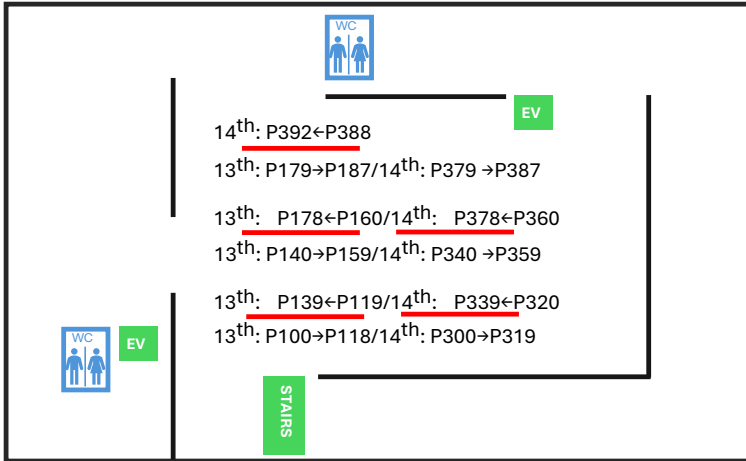

↑Entrance  
 To Venue Y →

## Sunday, 13 October

P179	P180	P181	P182	P183	P184	P185	P186	P187	
DIABETES AND METABOLIC DISEASES									
DIABETES AND METABOLIC DISEASES									
P178	P177	P176	P175	P174	P173	P172	P171	P170	P169
P140	P141	P142	P143	P144	P145	P146	P147	P148	P149
CARDIOVASCULAR					COST- EFFECTIVENESS AND ECONOMIC EVALUATIONS				
CARDIOVASCULAR									
P139		P137	P136	P135	P134	P133	P132	P131	P130
P100	P101	P102	P103	P104	P105	P106	P107	P108	P109
ADHERENCE								AI AND MACHINE LEARNING	
COVID - 19									
P701	P168	P167	P166	P165	P164	P163	P162	P161	P160
P150	P151	P152	P153	P154	P155	P156	P157	P158	P159
COST- EFFECTIVENESS AND ECONOMIC EVALUATIONS					COVID - 19				
CARDIOVASCULAR									
P129	P128	P127	P126	P125	P123	P122	P121	P120	P119
P110	P111	P112	P113	P114	P115	P116	P117	P118	
AI AND MACHINE LEARNING		ASTHMA AND COPD			AUTOIMMUNE				

## Monday, 14 October

PREGNANCY AND MATERNAL HEALTH									
				P392	P391	P390	P389	P388	
P379	P380	P381	P382	P383	P384	P385	P386	P387	
POLYPHARMACY				PREGNANCY AND MATERNAL HEALTH					
PEDIATRICS			OTHERS						
	P378	P377	P376	P375	P374	P373	P372	P371	P370
P340	P341	P342	P343	P344	P345	P346	P347	P348	P349
MALIGNANCY									
MALIGNANCY					KIDNEY				
P339	P338	P337	P336	P335	P334	P333	P332	P331	P330
P300	P301	P302	P303	P304	P305	P306	P307	P308	P309
INFECTIOUS DISEASE									
OTHERS			OSTEOPOROSIS			OPIOIDS AND PAIN MEDICATION			
P369	P368	P367	P366	P365	P364	P363	P362	P361	P360
P350	P351	P352	P353	P354	P355	P356	P357	P358	P359
MALIGNANCY								MEDICAL EDUCATION	
KIDNEY			INFECTIOUS DISEASE						
P329	P328	P327	P326	P325	P324		P322	P321	P320
P310		P312	P313	P314	P315	P316	P317	P318	P319
INFECTIOUS DISEASE									

# Ito International Research Centre (Venue Ito) B1 Floor

Sunday, 13 October

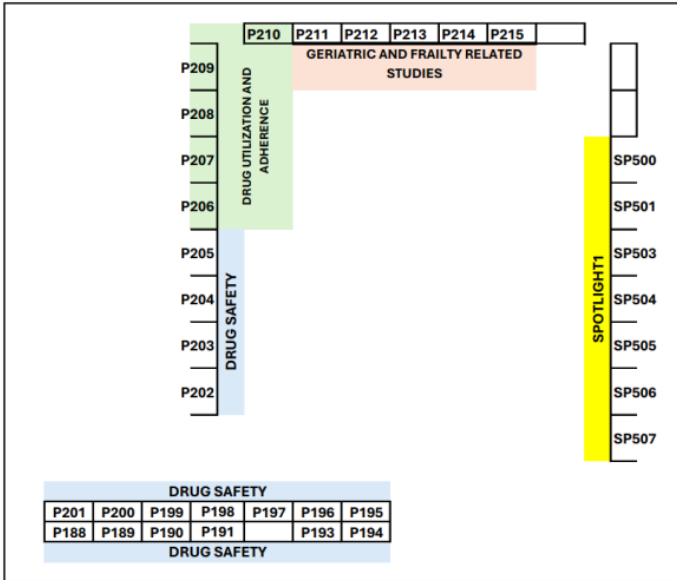

Monday, 14 October

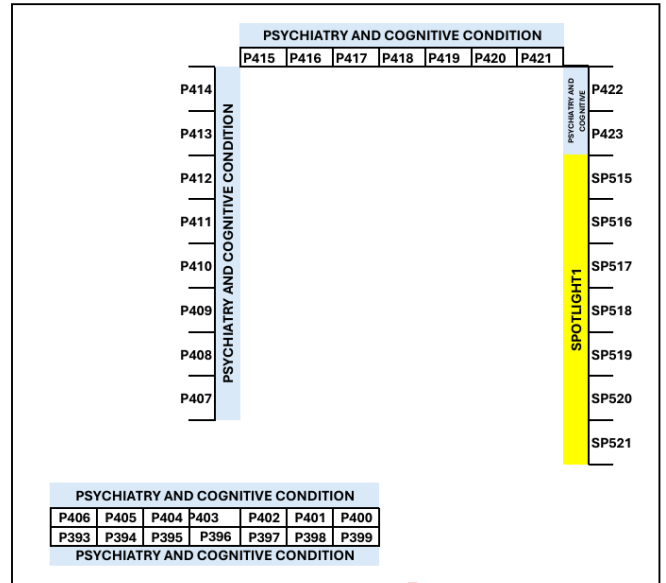

Sunday, 13 October

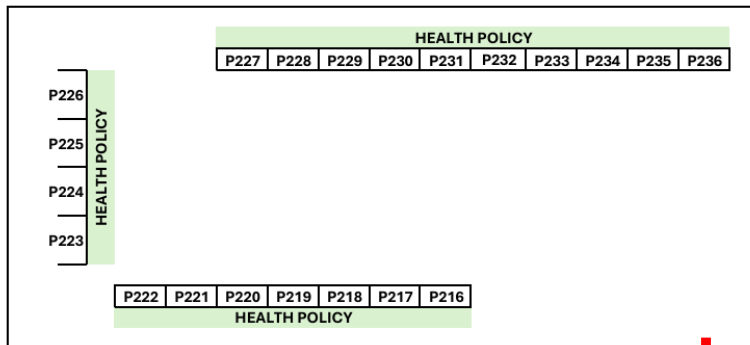

Monday, 14 October

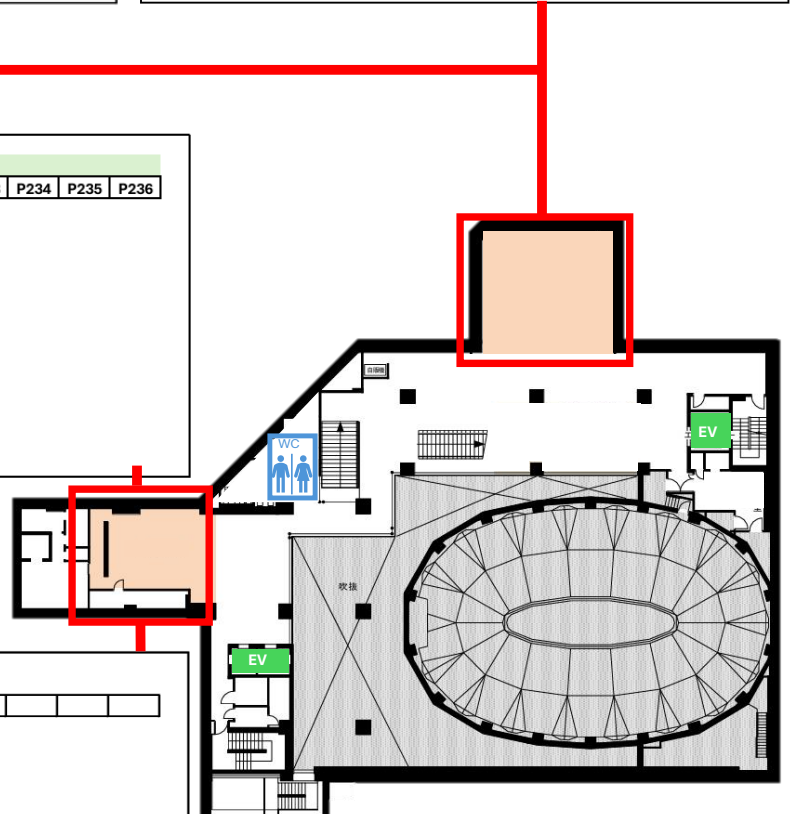
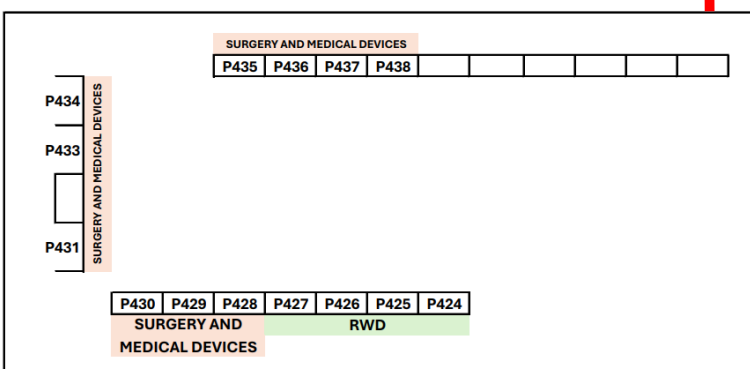

# Ito International Research Centre (Venue Ito) B2 Floor

Sunday, 13 October

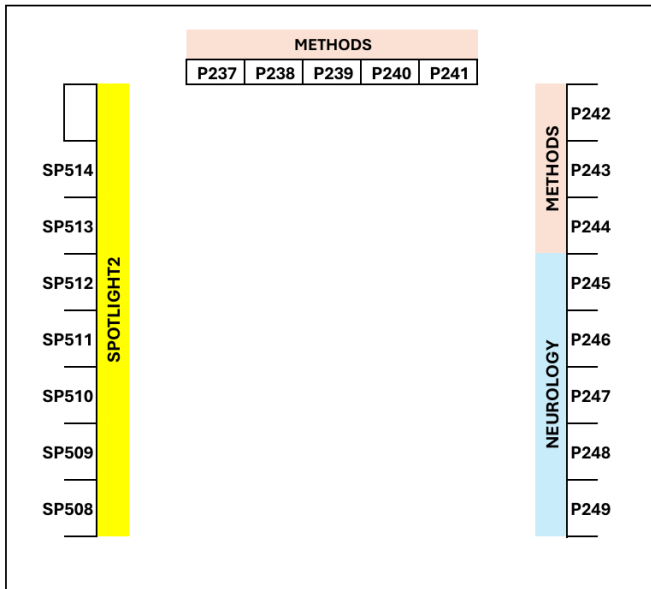

Monday, 14 October

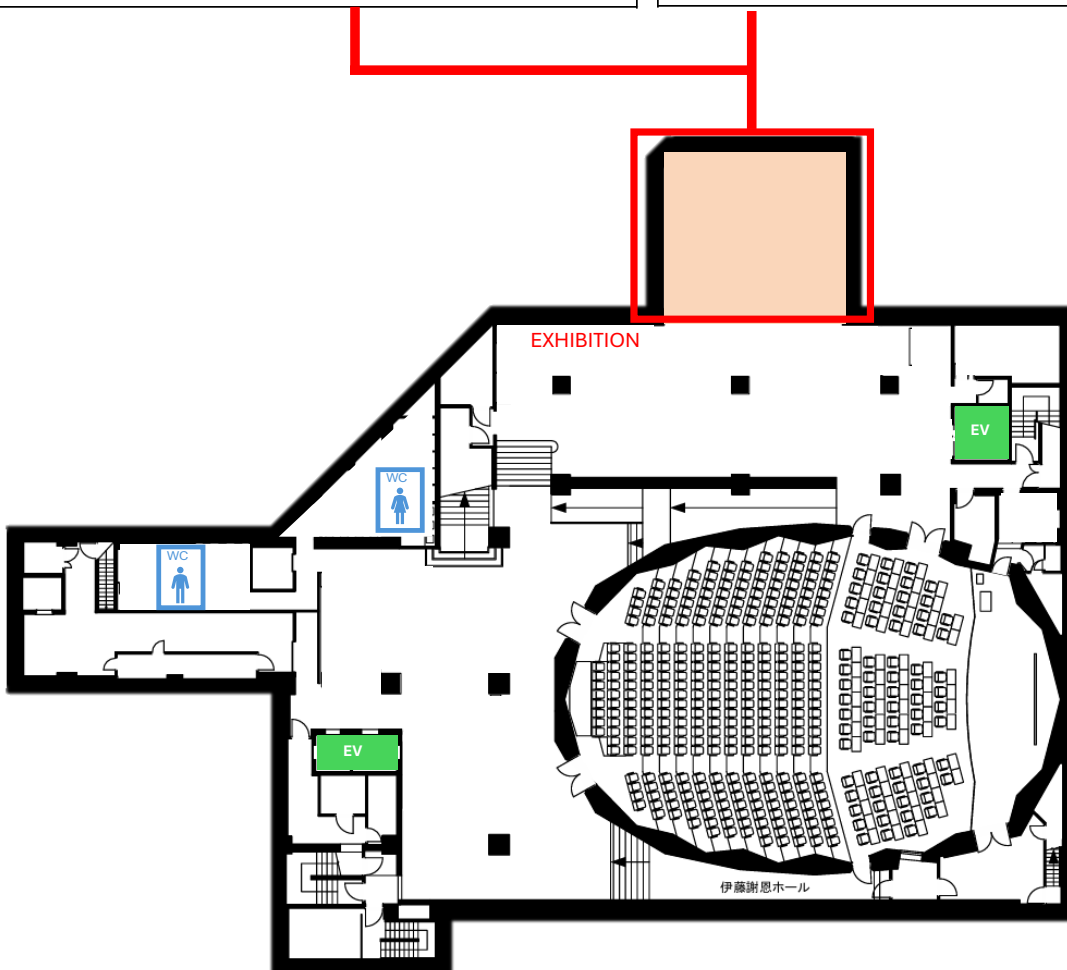
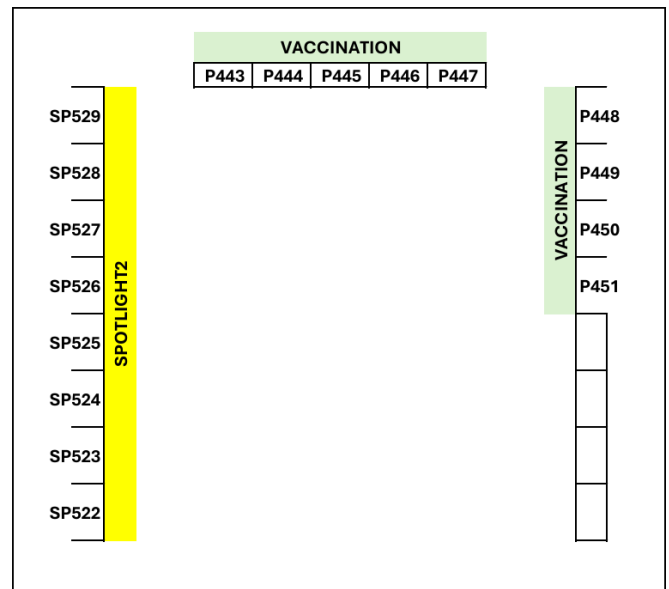

# 2024 Organizing Committee

## Local Host Committee

**Kotonari Aoki**

Chugai Pharmaceutical Co., Ltd.

**Keiko Asao**

Kappa Medical K.K.

**Chieko Ishiguro**

National Center for Global Health and  
Medicine

**Shinobu Imai**

Showa University

**Masao Iwagami**

Tsukuba University

**Hisashi Urushihara**

Keio University

**Nobuhiro Ooba**

Nihon University

**Kouji Kawakami**

Kyoto University

**Kiyoshi Kubota**

Drug Safety Research Unit Japan

**Hiraku Kumamaru**

The University of Tokyo

**Daisuke Koide**

The University of Tokyo

**Atsushi Goto**

Yokohama City University

**Tsugumichi Sato**

Tokyo University of Science

**Yoshinori Takeuchi**

Yokohama City University

**Shirou Tanaka**

Kyoto University

**Azusa Hara**

Showa Pharmaceutical University

**Takuhiro Yamaguchi**

Tohoku University

**Rie Nakajima**

Nihon University

## Program Committee

**Hiraku Kumamaru**

The University of Tokyo,  
Japan (Program committee Chair)

**Ben Bates**

Rutgers University, NJ, USA

**Edward Lai**

National Cheng Kung University, Taiwan

**Sallie Pearson**

UNSW Sydney, Australia

**Soko Setoguchi**

FISPE, Rutgers University, NJ, USA (ISC Chair)

**Krishna Undela**

National Institute of Pharmaceutical  
Education and Research, India

**Masao Iwagami**

Tsukuba University, Japan

**Daisuke Koide**

The University of Tokyo, Japan

**Arnold Chan**

National Taiwan University, USA

**Angelika Manthripragada**

Regeneron, USA

**Yea-Huei Kao Yang**

National Cheng Kung University, Taiwan

**Nicole Prat**

University of South Australia, Australia

**Jenni Ilomaki**

Monash University, Australia

**Sri Harsha Chalasani**

JSS College of Pharmacy, Mysuru, India

**Hu Li**

Gilead Sciences, Indianapolis, USA

**Frank May**

RGH Pharmacy Consulting Services, Australia

**Kiyoshi Kubota**

NPO Drug Safety Research Unit Japan, Japan

**Nam-Kyong Choi**

EWHA WOMANS UNIVERSITY, Korea

**Kai-Li Liaw**

Merck, USA

**Nobuhiro Ooba**

Nihon University, Japan

**Yoshinori Takeuchi**

Yokohama City University, Japan

**Chieko Ishiguro**

National Center for Global Health and  
Medicine, Japan

**Rie Nakajima**

Nihon University, Japan

## ISPE ACPE International Steering Committee

**Soko Setoguchi**

FISPE, Rutgers University, NJ, USA (ISC Chair)

**Ben Bates**

Rutgers University, NJ, USA

**Wei Zhou**

FISPE, Eli Lilly, USA

**Arnold Chan**

FISPE, National Taiwan University Taiwan,  
Taiwan

**Edward Chia-Jen Lai**

National Cheng Kung University, Taiwan

**Nam-Kyong Choi**

Ehwa Women's University Korea, Korea

**Tobias Gerhard**

Rutgers University, NJ, USA

**Yea-Huei Kao Yang**

FISPE, National Cheng Kung University,  
Taiwan

**Kiyoshi Kubota**

FISPE, President Japanese Society for  
Pharmacoepidemiology, Japan

**Caitlin Knox**

Regeneron Pharmaceuticals Inc., USA

**Kai-Li Liaw**

Merck Inc. PA, USA

**Meiyou Liu**

4th Military Hospital University, China

**Vincent Lo Re**

FISPE, University of Pennsylvania, USA

**Frank May**

FISPE, Australia

**Jingping Mo**

Pfizer Inc, PA, USA

**Jung-Won Park**

Yonsei University, Korea

**Byung Joo Park**

FISPE, Korea Institute of Drug Safety &  
Risk Management, Korea

**Gurumurthy Parthasarathi**

Pharmacovigilance Program, India

**Sallie Pearson**

UNSW Sydney, Australia

**Syd Phillips**

QuintilesIMS, WA, USA

**Masato Takeuchi**

Kyoto University, Japan

**Shiro Tanaka**

Kyoto University, Japan

**Krishna Undela**

National Institute of Pharmaceutical  
Education and Research, India

**James Vrac**

Executive Secretary ISPE, UK

**Sawaeng Watcharathanakij**

Ubon Ratchathani University, Thailand

**Ian Chi Kei Wong**

University of Hong Kong, China

**Songlin Xue**

Astellas, Chicago, USA

**Siyan Zhan**

Peking University, China

**Wei Zhou**

FISPE, Merck Inc. PA, USA

**Lisa Pont**

FISPE, University of Technology Sydney,  
Australia (ISPE President)

**Suk-Hyang Lee**

College of Pharmacy, Ajou University, Korea

# Sponsorship

## Platinum Sponsor



## Exhibitors

メディカル・データ・ビジョン株式会社  
DeSCヘルスケア株式会社  
ArkMS株式会社 (アークメディカルソリューションズ)  
株式会社MeDiCU  
TOPPANホールディングス株式会社  
IQVIAソリューションズ ジャパン合同会社  
株式会社4DIN  
一般財団法人日本医薬情報センター  
独立行政法人医薬品医療機器総合機構  
慶應義塾大学薬学部医薬品開発規制科学講座  
京都大学大学院医学研究科 臨床統計学講座

## Banner

DeSCヘルスケア株式会社  
ArkMS株式会社 (アークメディカルソリューションズ)

## Other Sponsors



# DeSCデータベースは 全領域全世代 コホートデータ

健保

国保

後期高齢

年齢を問わず捕捉可能!

## アンケート/ライフログデータで 日常生活の情報を可視化

DeSCデータベースを活用した研究事例\*の紹介 (健保データのみ分析)

分析事例

kencomアプリ登録利用が歩数増加と関連

● 歩数: kencom登録前後の月別の1日あたり平均歩数 (N = 12,602人)

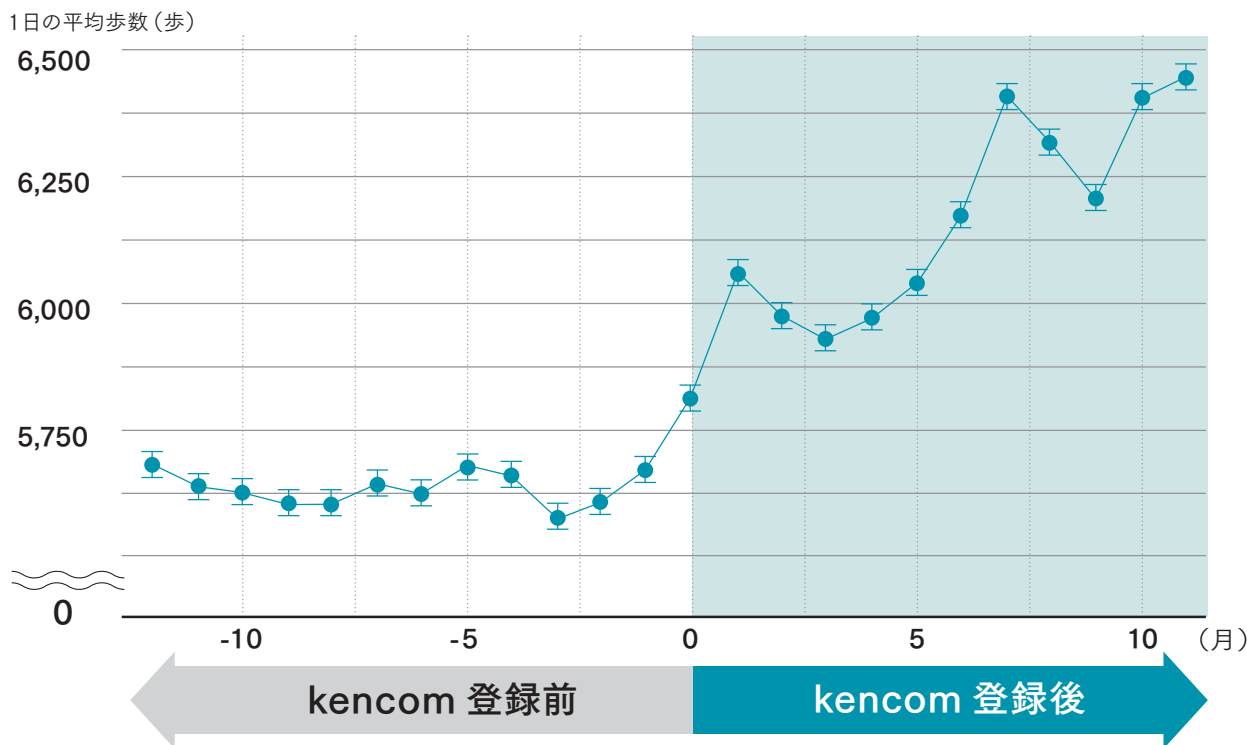

\* 出典 Journal of Medical Internet Research (2021;23(4):e21622) Effects of an mHealth App (Kencom) With Integrated Functions for Healthy Lifestyles on Physical Activity Levels and Cardiovascular Risk Biomarkers: Observational Study of 12,602 Users <https://www.jmir.org/2021/4/e21622>



病院+保険者データ（健保・国保・後期高齢）で  
全国全年代をカバーし、新たに電子カルテデータの提供が可能、  
従来の広さに深さを加えた診療実態把握が可能に！

# 日本最大級の

Access One of Japan's Largest Comprehensive Hospital and Insurance Databases!  
**Real-World Data**  
Harness for Deeper Insights

豊富な実績

# 論文化 600

Proven Expertise with **600+** Groundbreaking Publications

病院  
データベース

# 4,900

Hospital Database **49million** Patients

保険者  
データベース

# 2,300

Health Insurance Database **23million** Patients

+ 新たに電子カルテデータの情報の利活用も可能  
Unlock the Power of Newly Available  
Electronic Health Records Data!



メディカル・データ・ビジョン株式会社  
Medical Data Vision Co., Ltd.

101-0053 東京都千代田区神田美土代町7番地 住友不動産神田ビル10F

<http://www.mdv.co.jp/>

MDV EBM insight.

診療データベースサービス  
最新情報・サービスについて→





# SHIONOGIは いま、まさに 立ち向かっている。

半世紀以上、  
感染症と向き合い続けてきた誇りを胸に。  
ヘルスケアの未来を見据え、  
健やかで豊かな人生に貢献するために。



2024.3.A42

## 救急集中治療領域の RWD 提供&研究コンサル事業

ACPE2024 ブース出展中

### SERVICE 1 世界最大級の唯一無二のデータベース「OneICU」 by MeDiCU (メディキュー)

1分置きの時系列データ、臨床病名、バイタルサイン、血液検査、人工呼吸器、アウトカムが揃った唯一無二のデータベースが日本に誕生。実際の臨床現場を経験し、ハーバード大学で疫学研究を行っていた医師だからこそできた「OneICU」  
保険者データや DPC データでは実現不可能な研究を支援し、実臨床に沿った研究支援で製薬会社・医療業界に革命を起こします。

#### POINT 1

##### 世界最大規模のデータベース

2024年9月現在、16施設の研究参加が確定、本年度中に取得可能なデータ数は約17万症例、約10億回の脈拍の測定回数を誇る世界最大のバイタルサインデータベースとなります。

#### POINT 2

##### クリーニング済データ

施設によって形式の異なる臨床病名などの電子カルテ情報をメディキューのOne ICUでは全て標準化をしているため、データクレンジングの手間を省いて研究にフォーカスすることが可能です。

#### POINT 3

##### 1分毎・時系列のデータ

ICU入室後の時系列データを1分毎に収集しているため、薬剤投与と患者の状態悪化・改善のタイミングを厳密に識別できます。このため、投薬前後のバイタルサインや採血結果の変化を正確に解析可能です。

### SERVICE 2 ハーバード大疫学者によるデータベース研究の伴走支援

#### 社内教育向け日本語版ハーバード流医療統計セミナー

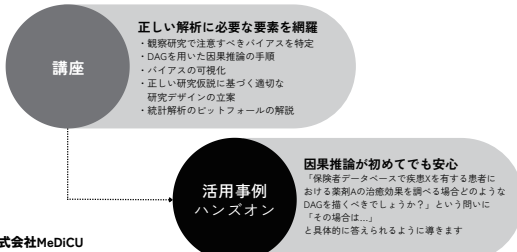

株式会社MeDiCU  
代表取締役 木下 喬弘

大阪の救命救急センターで35年間の臨床経験を経て、2019年に渡米。Philips Research North Americaで集中治療室の医療AI開発に携わる。2023年に帰国し株式会社MeDiCUと医療統計セミナーの合同会社EpiTAPを創業。2020年ハーバード公衆衛生大学院卒業。

#### ハーバード疫学者によるデータベース研究支援

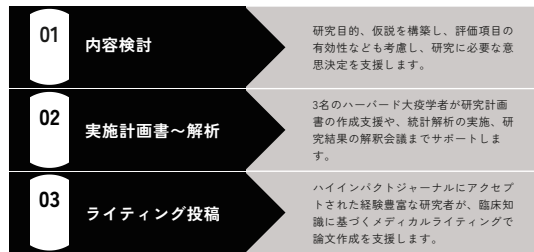

お問い合わせ: info@medicu.co.jp  
<https://www.medicu.co.jp>

QRコードを読み込んでいただくことで、メールの送信が可能です。  
送信された定型文に必要な情報をご記入のうえ、ご返信ください。



臨床エビデンス（RWE）創出を加速させる、  
リアルワールドデータ（RWD）を活用したトータルソリューション

# Evidence Driver



- 01 臨床研究企画コンサルティング
- 02 DPC + 追加収集データ臨床研究支援  
(メディカル・データ・ビジョン社との協業)
- 03 SS-MIX2 + 追加収集データ臨床研究支援  
(ケーアイエス社との協業)

## 本コンセプトにおける3つの強み

**Science**：幅広い疾患領域と科学的な専門性の提供能力  
**Network**：グループ会社・アカデミア・外部パートナーとのネットワーク力  
**Innovation**：最新の医療情報・IT技術を駆使した革新力



イーピーエス株式会社

TEL: 03-5804-7577  
MAIL: prj-sd@eps.co.jp



お問い合わせはこちら

リアルワールドデータ  
活用で臨床研究をより早く、より効果的に！